



Peekaboo!

Check in with loved ones — while having fun!

CS147 Fall 2022

Jason, Derek, Karson, Winston



Team Presentation



Jason Lin

Sophomore

CS, HCI



Derek Hwang

Coterm

CS, HCI

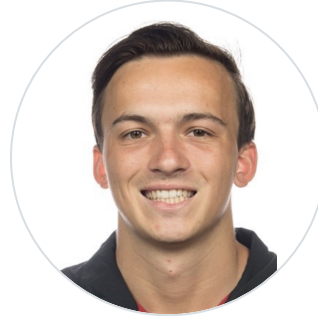

Karson Lippert

Senior

CS, HCI



Winston Shum

Senior

Econ

Problem

People cannot check up on others in an easy manner without being intrusive.



Solution

Instantly share updates to all family/close friends through a simple check-in, photos, or fun in-app activities.

Value Proposition



Quickly and easily send updates to family
and close friends for a *simple check in*



Outline of Presentation



1. Heuristic Evaluation Results
2. All UI and Product Revisions
3. Prototype Implementation Status
4. Demo of Prototype (so far)



1.

Heuristic Evaluation Results

Analyzing design errors...



High-Level Summary of Results



Most Violated Heuristics

1. H4: Consistency & Standards: 22
2. H3: User Control: 8
3. H7: Efficiency of Use: 7
3. H11: Accessible: 7

Severity Violation Totals

Severity 0-2 Violation #: 50

Severity 3-4 Violation #: 17

Total Severity Violations: 67

High-Level Summary of Results



- Inconsistencies in fonts, grid misalignments, and small text/buttons
- Three tabs to check in and hard to navigate other parts of the app

High-Level Summary of Results

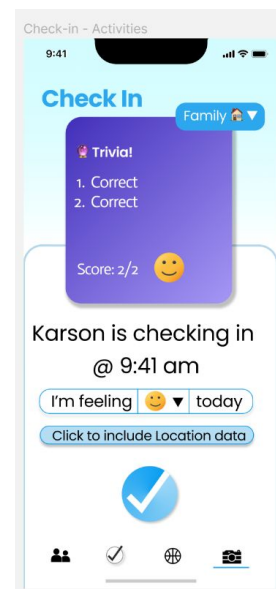
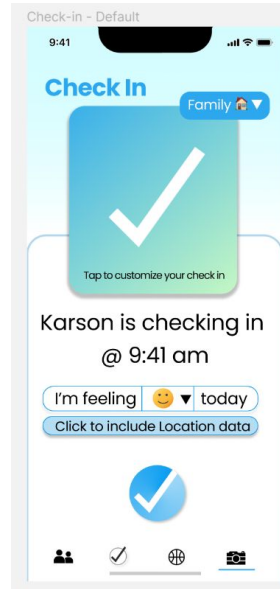
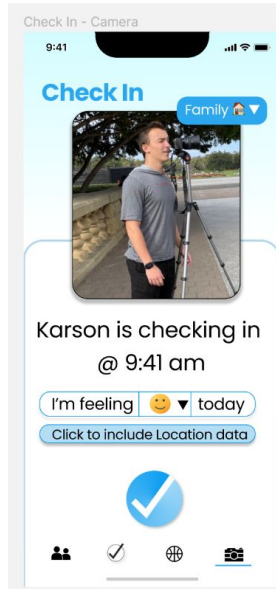

Sev 3-4 Details



- Need to be able to change feed to view a different group
- Navigation bar adjustments
- More group customization options and preferences

Sev 3-4 Details



Change feed view and navigation bar changes

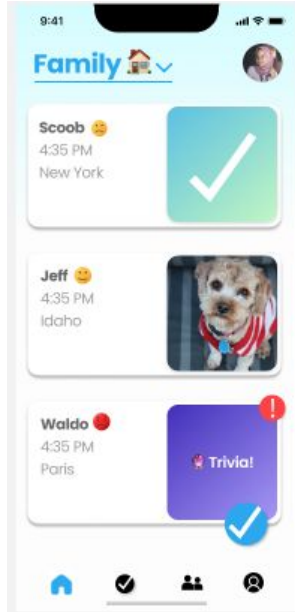

Manage your own groups and groups you were added to

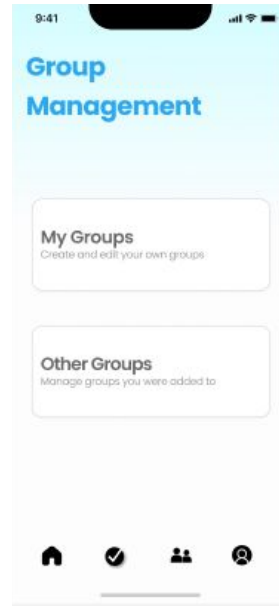

Remove yourself from groups and edit viewing preferences

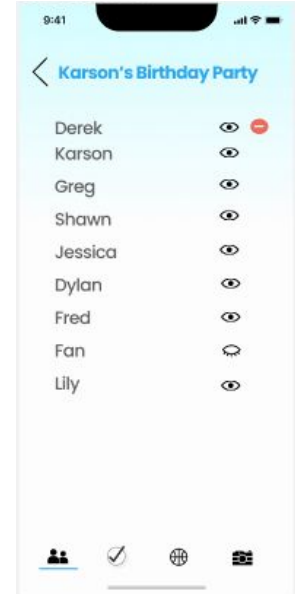



2.

All UI and Product Revisions

Looking at design changes...



Before and After Shots

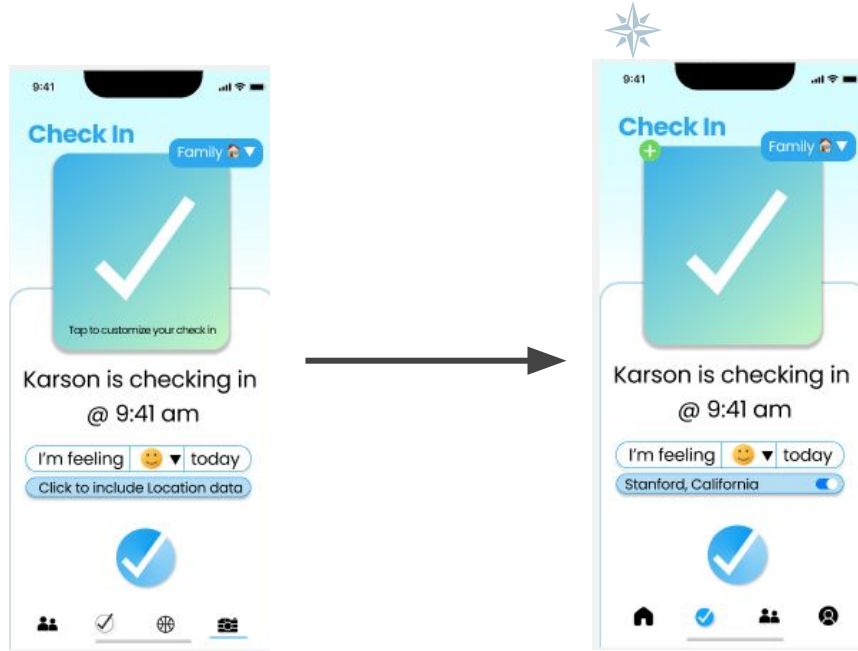

- Navigation bar changes
- Location removal
- Single check in page

Before and After Shots

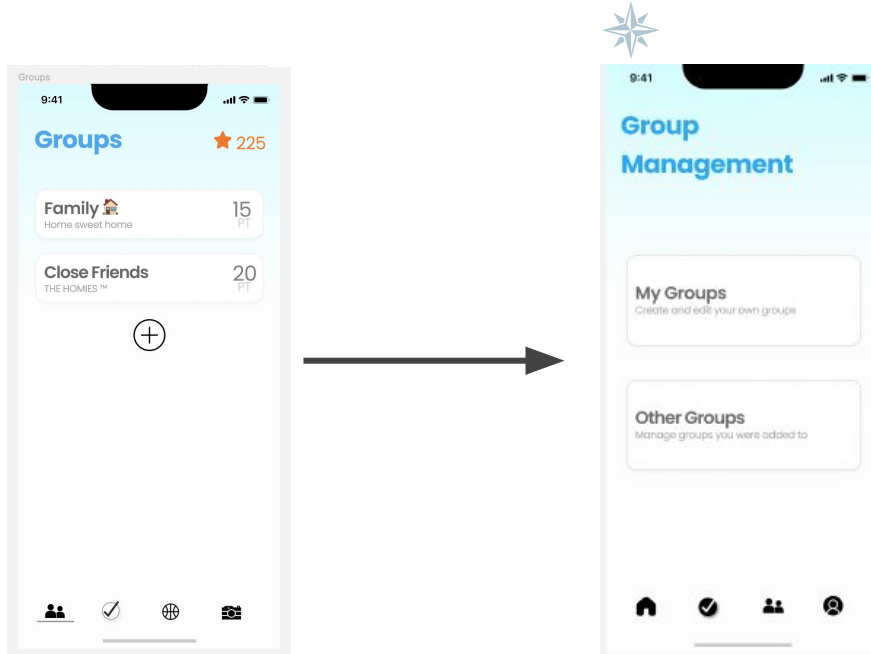

- Manage your own groups
- Manage groups you were added to

Before and After Shots

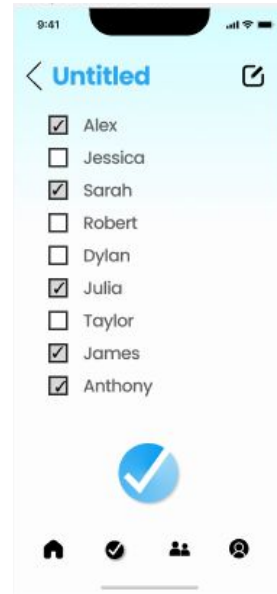
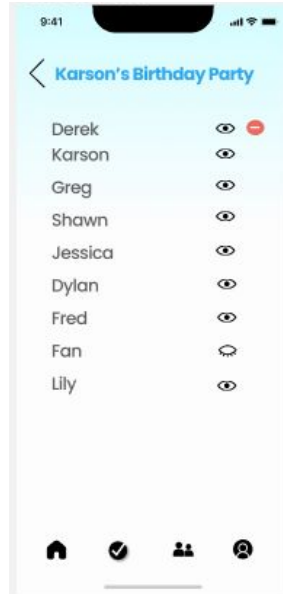
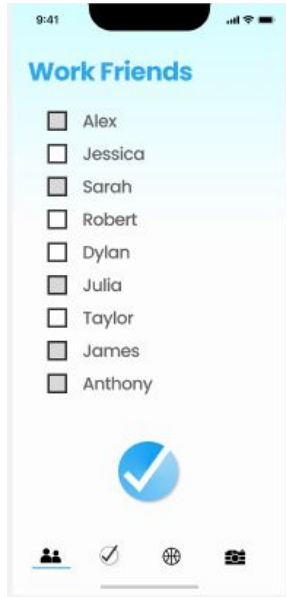

- Edit viewing preferences
- Remove yourself from groups

Before and After Shots

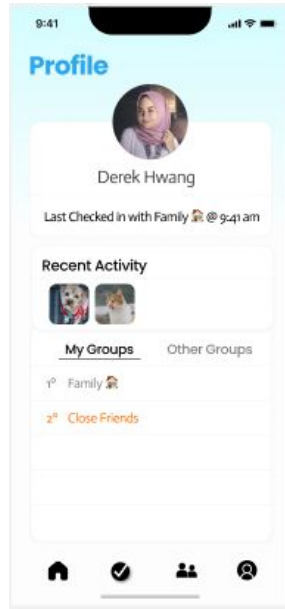
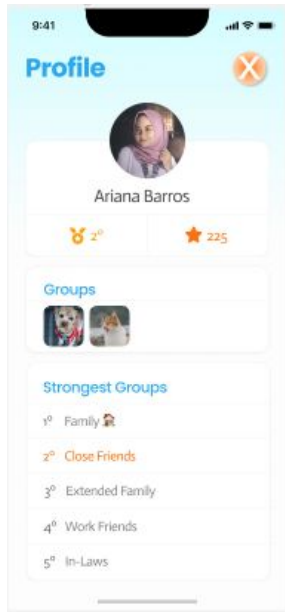

- Profile icon added to navbar
- Last check in time
- Recent check in sneak peak
- List of all groups

3.

Prototype Implementation Status

Checking implementation progress...



Framework/Tools Being Used



- Expo CLI
- Supabase (check-in and groups data)

 Expo  supabase

Implemented Features



- Default Check-In
 - Group selector
 - Mood selector
 - Location switch (On and Off)

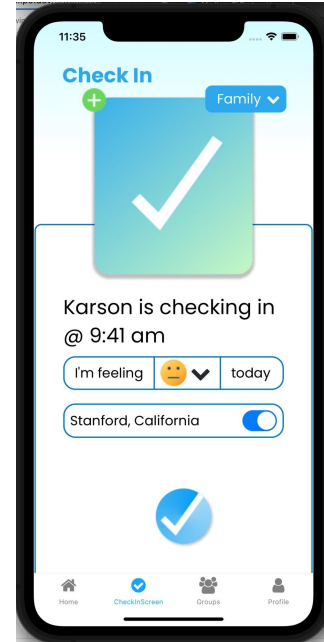

Implemented Features



- Profile Page
- Navigation Bar
- Groups dropdown (feed page)
- Viewing your groups and other groups
- Creating New Groups Task Flow
- Check-In Details Screen

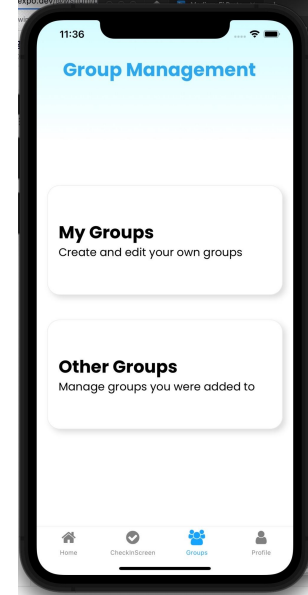
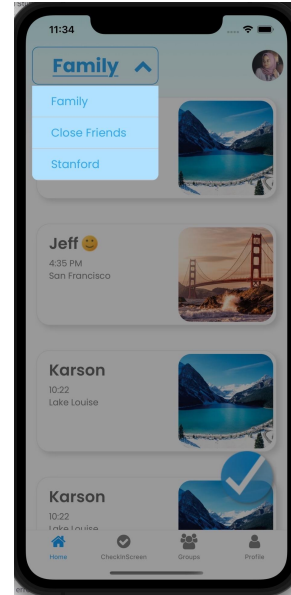

Unimplemented Features & Plans to Finish



- Create custom activity and activity check-in
- Photo check-in
- Complete updates in next few days, then polish everything

Wizard of Oz Techniques



- Feed screen automatically updates new check-in from the user
- App automatically stores check-in and groups data

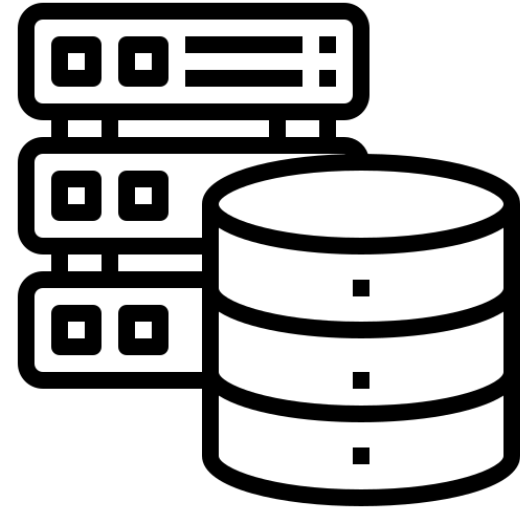

Hard-coded Aspects



- Photos used in check-in
- Emojis used for Moods
- Name, Time, and Location of individual check-ins
- Profile and other user information
- Activities check-in information



Issues/Questions



- Unsure about how to make new check-ins upload to the top of feed screen



A historical map of the North Atlantic and Europe. The map shows the North Atlantic Ocean, the Gulf of St. Lawrence, and the Bay of Biscay. Red lines are overlaid on the map, forming a network that connects various locations across the Atlantic and Europe. The network is denser in the North Atlantic, particularly around the Gulf of St. Lawrence and the Bay of Biscay, and extends across Europe from the British Isles to the Mediterranean. The map includes labels for various geographical features, cities, and regions. A white box with a blue border is overlaid on the map, containing the text '4. Demo of Prototype' and 'Current prototype implementation...'. A blue compass rose is located below the text in the white box.

4.

Demo of Prototype

Current prototype implementation...





THANKS!

Any questions?

[Figma Link](#)