

NeighborAid: Med-Fi Prototype

Team 2: Chester, Seb, Hannah,
Kevin

PROBLEM #1 : Adding a Comment

One Problem that we saw with our low-fi prototype was that people who tested the design were oftentimes confused with the way commenting worked, unsure as to what certain icons did, and how to add a comment in the first place. We fixed this by using more direct iconography and methods for indicating how to comment on something.

Taskflow #1 - Adding a comment

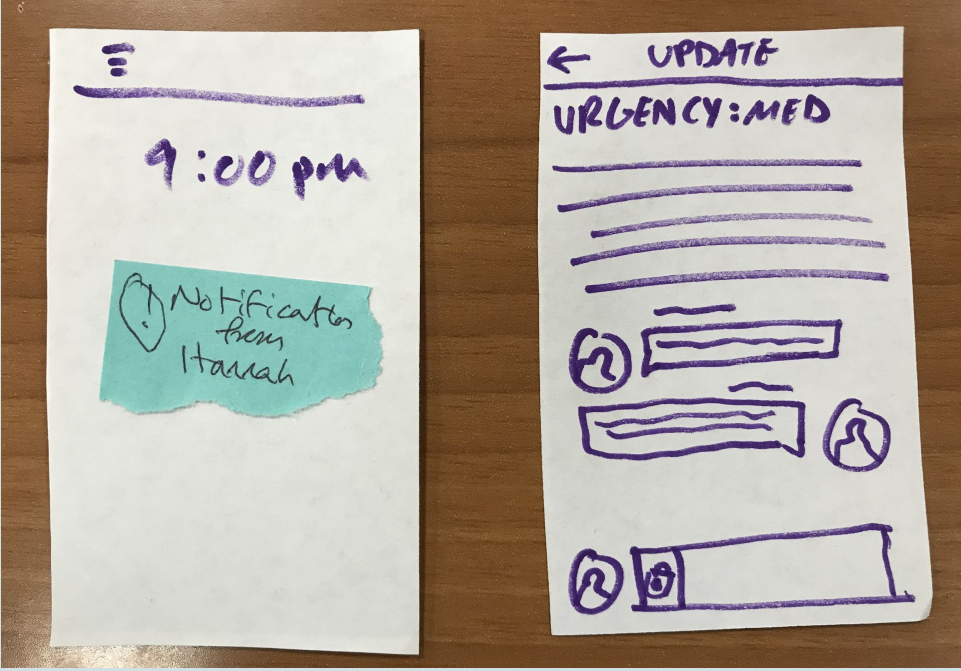

Locked Phone Screen

Update Details Page

Taskflow #1 (Figma) - Adding a comment

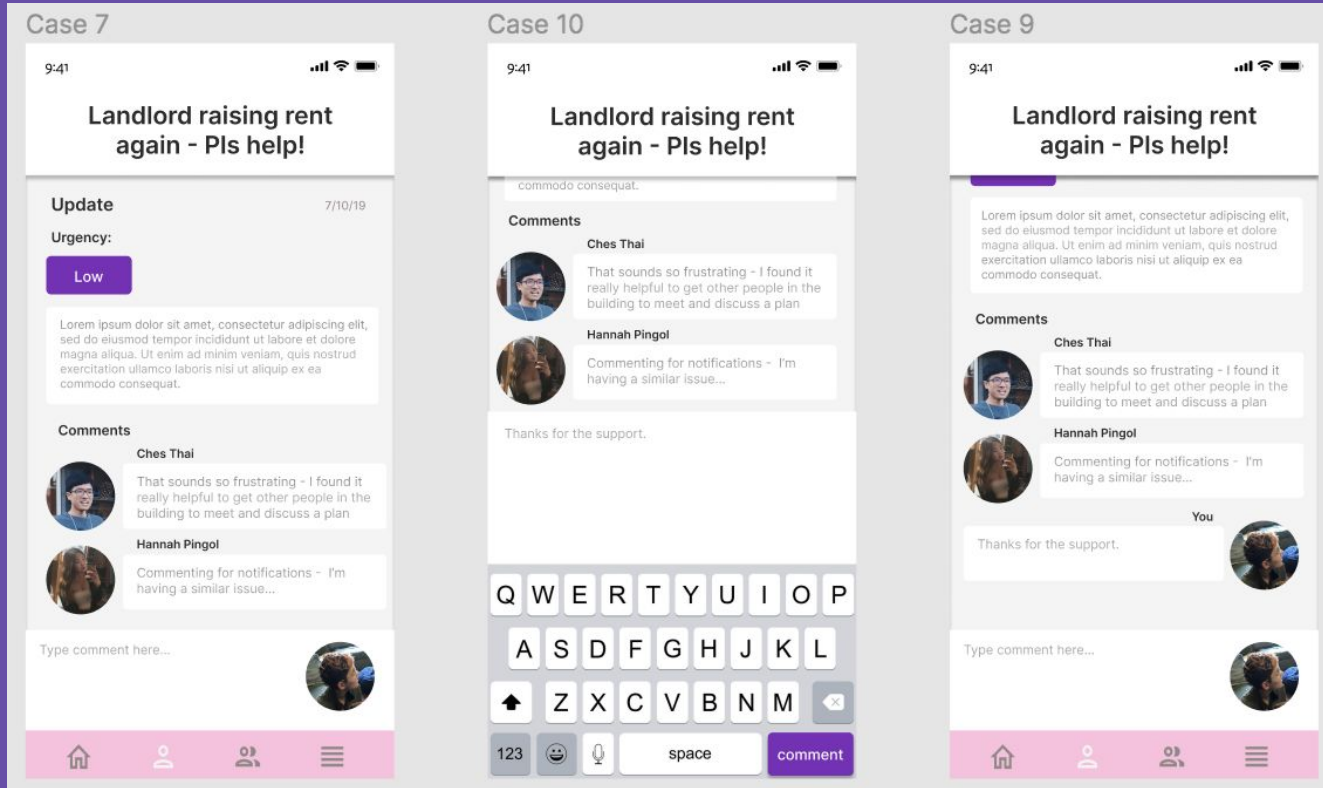

Update Details Page

Keyboard Pop-up

Comment Added

Problem #2: Creating an Update

There was a lot of confusion regarding some of the icons that we used for adding an update, so we went with something more conventional; we used the words themselves and put them inside the buttons to make it more convenient and easier to understand.

Taskflow #2 - Create an update

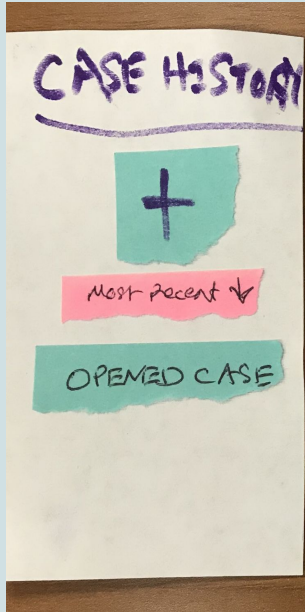

Case History Page

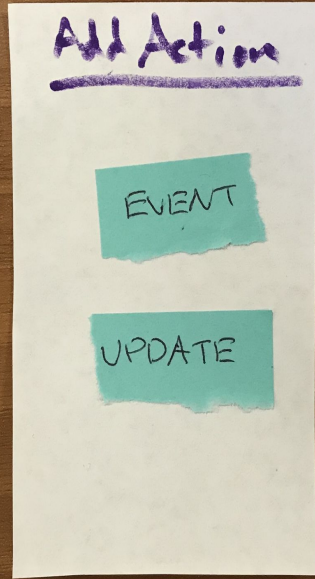

Action Selection

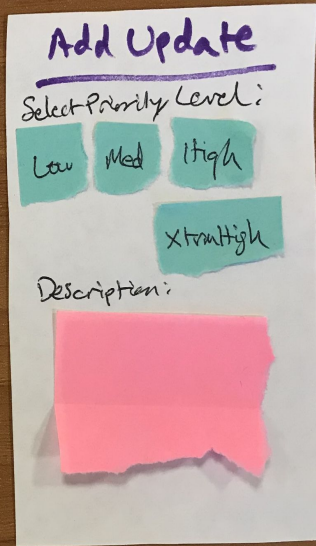

New Update Creation page

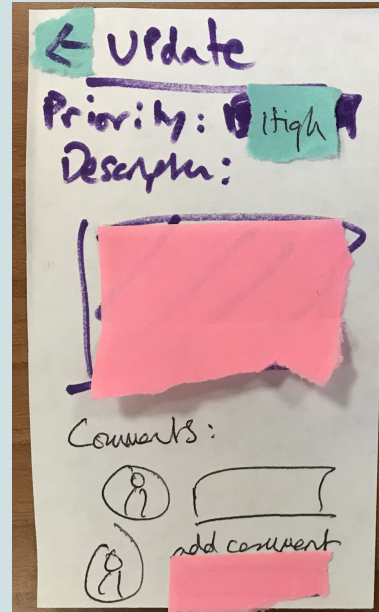

Update Details Page

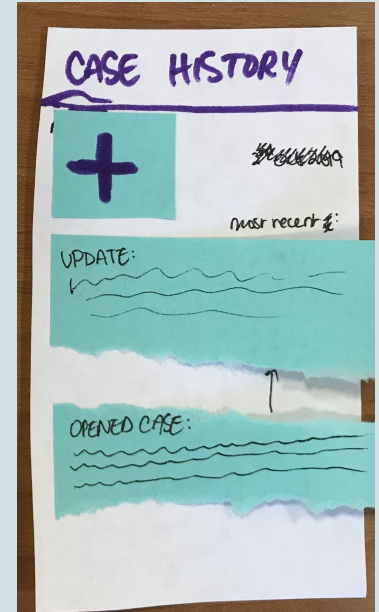

Case History Page

Taskflow #2 (Figma) - Create an update

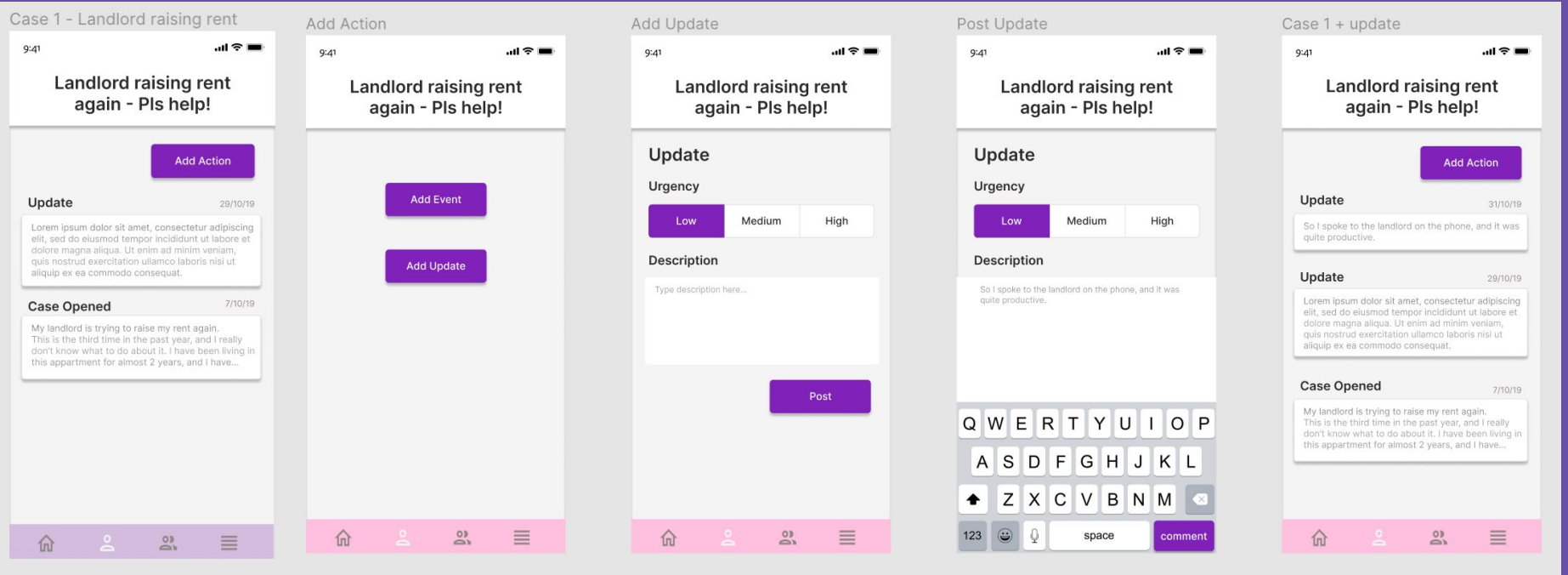

Case History Page

Action Selection

New Update Creation page

Update Details Page

Case History Page

Problem #3: Creating an Event

The last problem we came across was that those testing our original prototype felt that a lot of it was crammed onto one screen/window, and in order to fix this feeling of being overwhelmed with prompts and information, we streamlined the process to multiple screens.

Taskflow #3 - Create new event

← **EVENT**

Type: [REDACTED]

location: [REDACTED]

date: [REDACTED]

desc: [REDACTED]

COMMENTS:

[REDACTED]

[REDACTED]

Type comment here... [REDACTED]

Event Details Page

CASE HISTORY

+ [REDACTED]

most recent ↓

EVENT:

[REDACTED]

UPDATE

[REDACTED]

OPENED CASE

[REDACTED]

Case History Page

Taskflow #3 (Figma) - Create new event

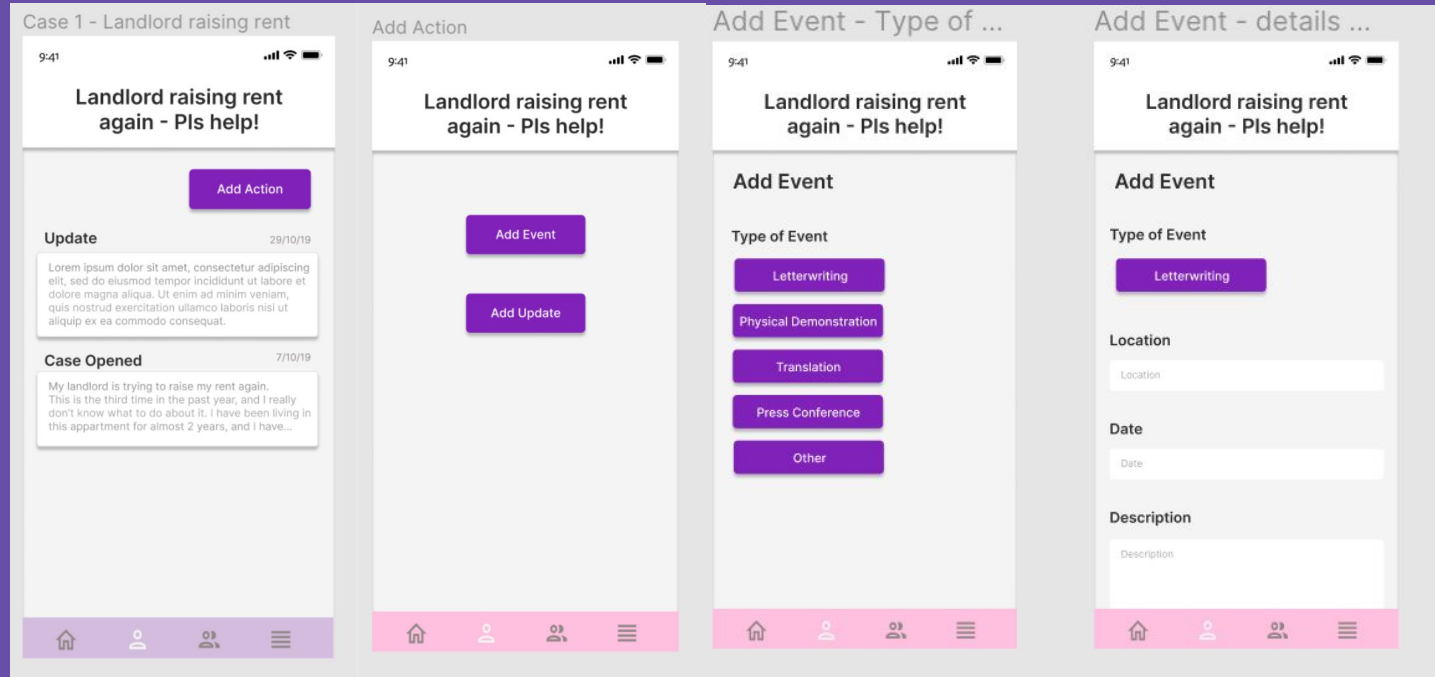

Case History Page

Action Selection

Event Type

Event Details

Taskflow #3 (Figma) - Create new event

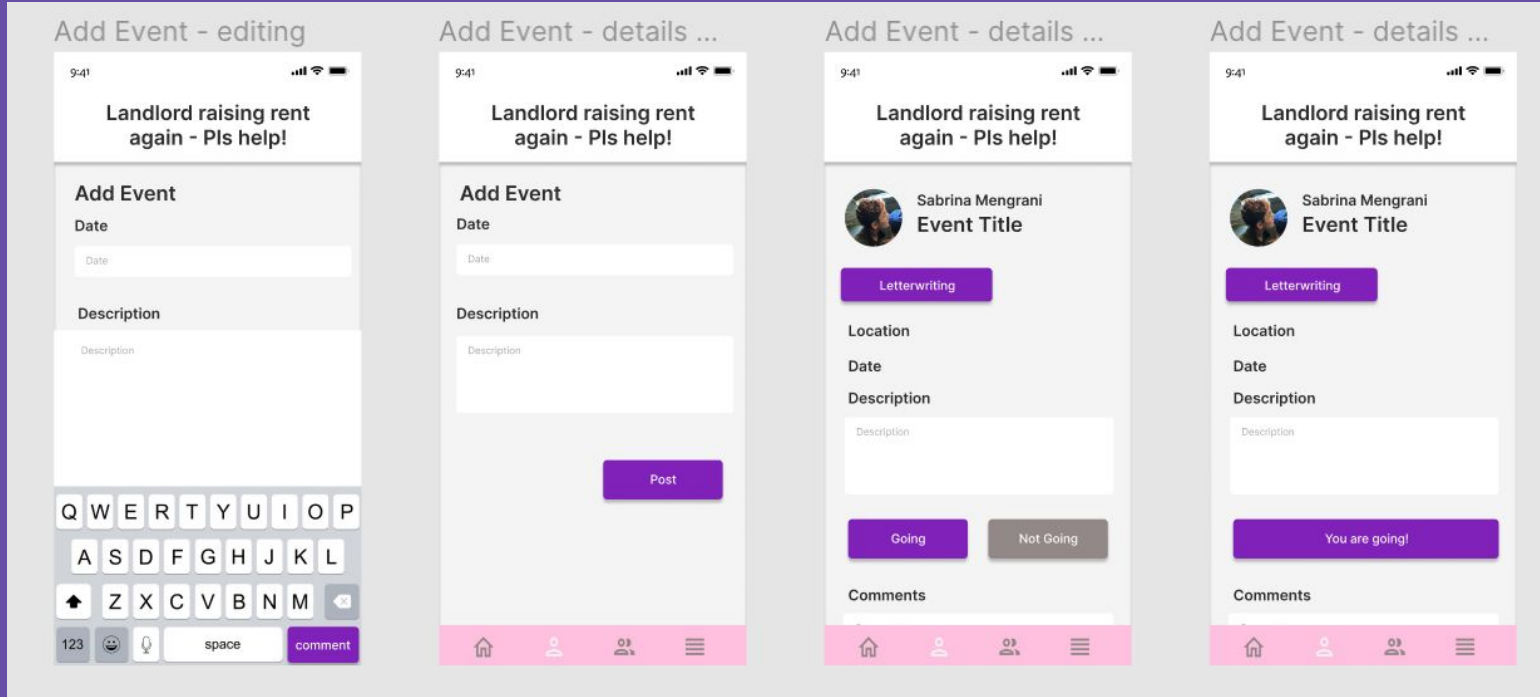

Event Details

Post Event

Event Details Page

Going to Event

Prototyping Tools



Notability

(for drawing out flows on
iPad)



Figma

(for med-fi prototyping)

Figma: Pros & Cons

PROS

- ❖ Beginner friendly
- ❖ Easy to add user interactions (clicking buttons, switching between screens)
- ❖ Easy to add templates and icons



Figma

(for med-fi prototyping)

CONS

- ❖ Can become very convoluted as you increase number of tasks in the prototype
- ❖ Doesn't have direct plug-in for integration into a website

Limitations/tradeoffs of the current prototype

Since we were restricted to the animations on Figma, some user gestures and animations were left out or simplified. For example, in our final version, users will be able to scroll down the screen to view more updates on the home page, to read more about events, to view more of the users' profiles, etc. Our final implementation will also include a filter on the homepage that allows users to view posts by post date, by location, etc. Other animations, like the transitions between the Going to Event/Not Going/Maybe Going button and Commenting button, will eventually be more seamless and easier to navigate. Since we focused on our three main tasks for this prototype, we left out certain features such as the onboarding page. We also only allow the user to experience the prototype through one user and one case, and only allow the user to view one of their groups. Other features, such as creating a new event, case, or update, are visually represented but are not actually available for the user to act upon.

-

-

Hardcoded features

Some of the hardcoded features include:

- Any of the other features (excluding the ones featured in this presentation)
- Some of the choices a user could make on the app

Figma Prototype

Prototype Link:

<https://www.figma.com/proto/kw33NNEzy1cjLQvlB1MyMJ/neighbouraid?node-id=1%3A2&scaling=scale-down>

Figma File Link:

<https://www.figma.com/file/kw33NNEzy1cjLQvlB1MyMJ/neighbouraid?node-id=0%3A1>