

Polytone

Medium-fi Prototype

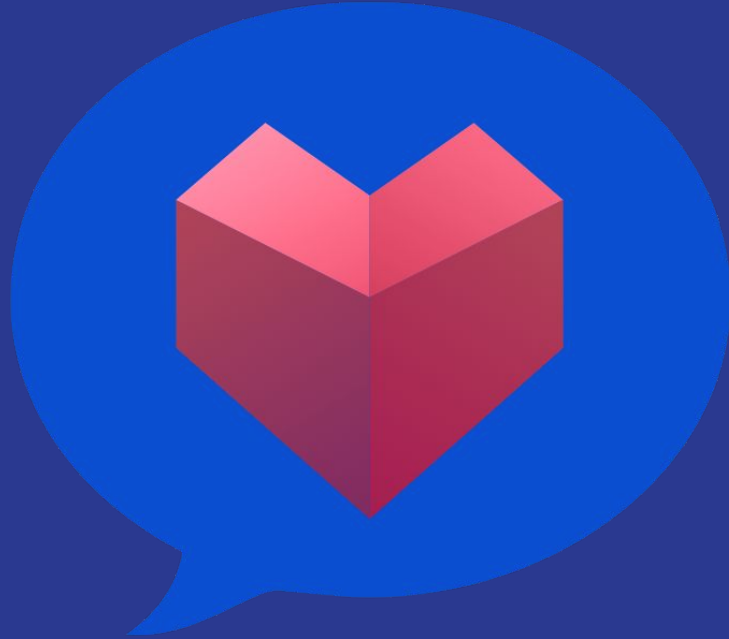

By: A Team

Team



Alejandrina G.R.



Ammar A.



Ahmed S.



Abdallah A.

Overview

- Mission Statement
- Tasks
- Interface Design
- Prototype Overview



Mission Statement

“Your **voice** is more than just words”

We aim to be able to display emotions through text to benefit those with deafness and beyond.



Tasks

Slight changes were made to the specificity of the tasks at hand



Task 1 (Simple)

As a deaf student, I want to be able to visually understand the volume of a lecture.

(change made to focus simply on volume for now)



Task 2 (Medium)

I want to communicate with deaf people in 1-on-1 conversations without the need to learn sign language.



Task 3 (Complex)

I want text to reflect my emotion and deliver it to other people so that they don't necessarily need sound.



Revised Interface Design



Design Changes



Design Change #1

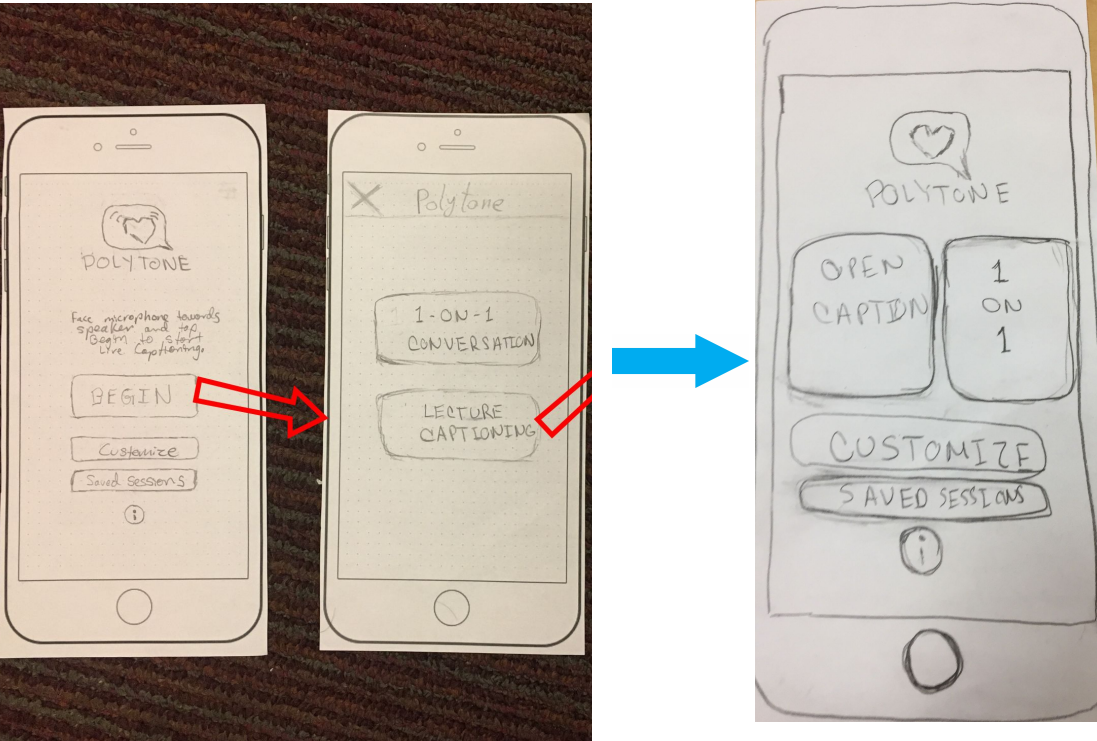

- Lecture Captioning and 1-on-1 Conversation options accessible from main screen
- No useless intermediate screen any longer
- No small explanation on main screen

Rationale

Some of the interviewees expressed concern with how cumbersome it was to navigate back and forth through countless screens. Thus, we decided, to simplify it as much as possible in many instances. In this instance, we removed the intermediate screen and made two other screen accessible from the main page.



Design Change #2

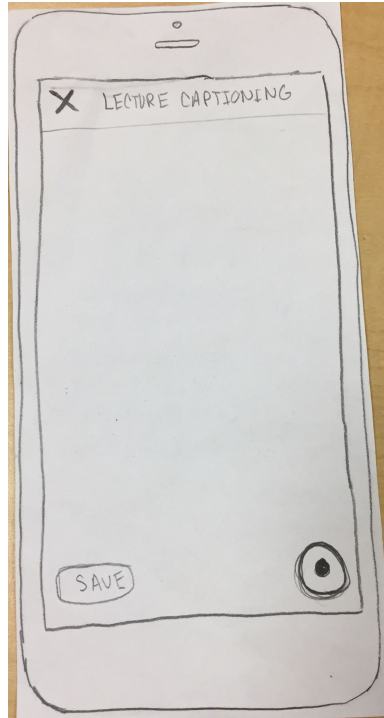
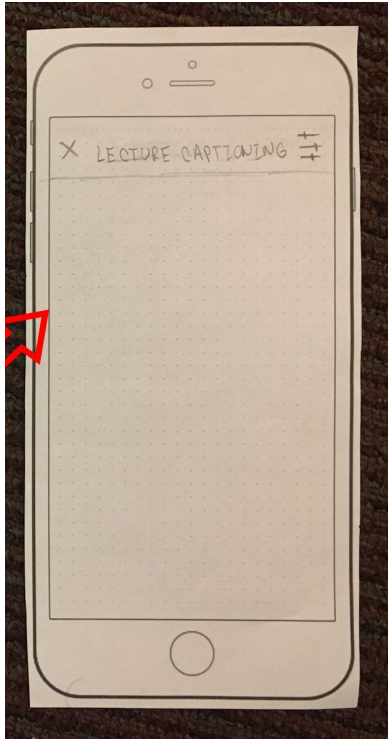

- Add a record (and a pause button) to easily and directly record a lecturer's captions (transcript with emotions)
- Add a save button directly to the lecture captioning screen

Rationale

One of our interviewees found it very time consuming to save a lecture then navigate all the way back to the main screen in order to share a saved session. So, we thought it necessary to simplify the process by making it possible to share a session directly after saving it.



Design Change #3

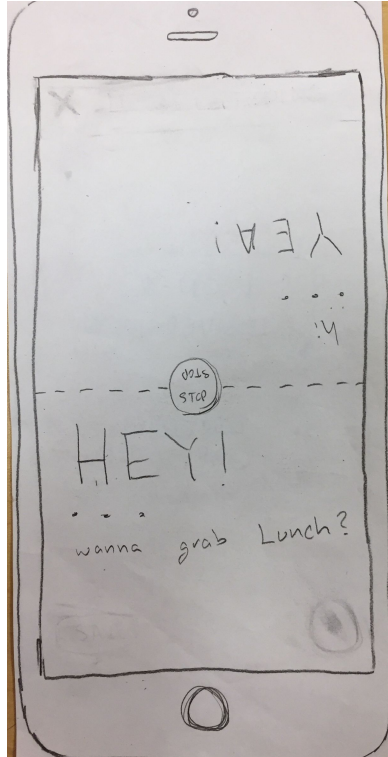
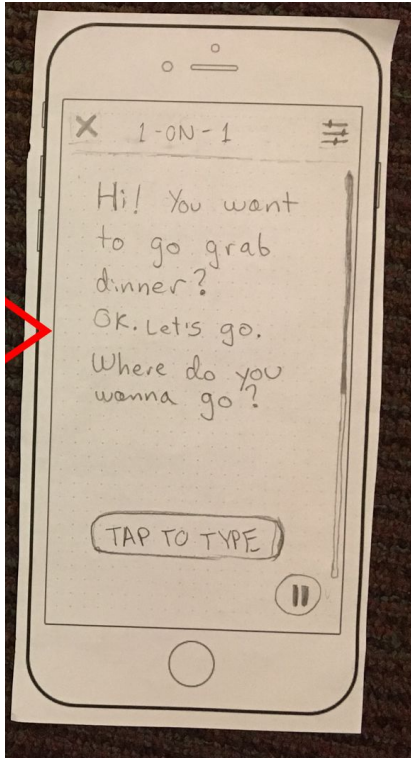

- Making the 1-on-1 conversation screen more enjoyable and interactive between two participants by halving a split-screen format



Rationale

Our interviewees expressed concerns with the extreme similarity between lecture captioning and having a 1-on-1 conversation. Thus, fulfilled our original goal of making the 1-on-1 conversation aspect more interactive and enjoyable through creating a split-screen format for the two participants to directly and easily communicate with one another.



Task Flows



Task 1- Lecture Captioning (Simple)

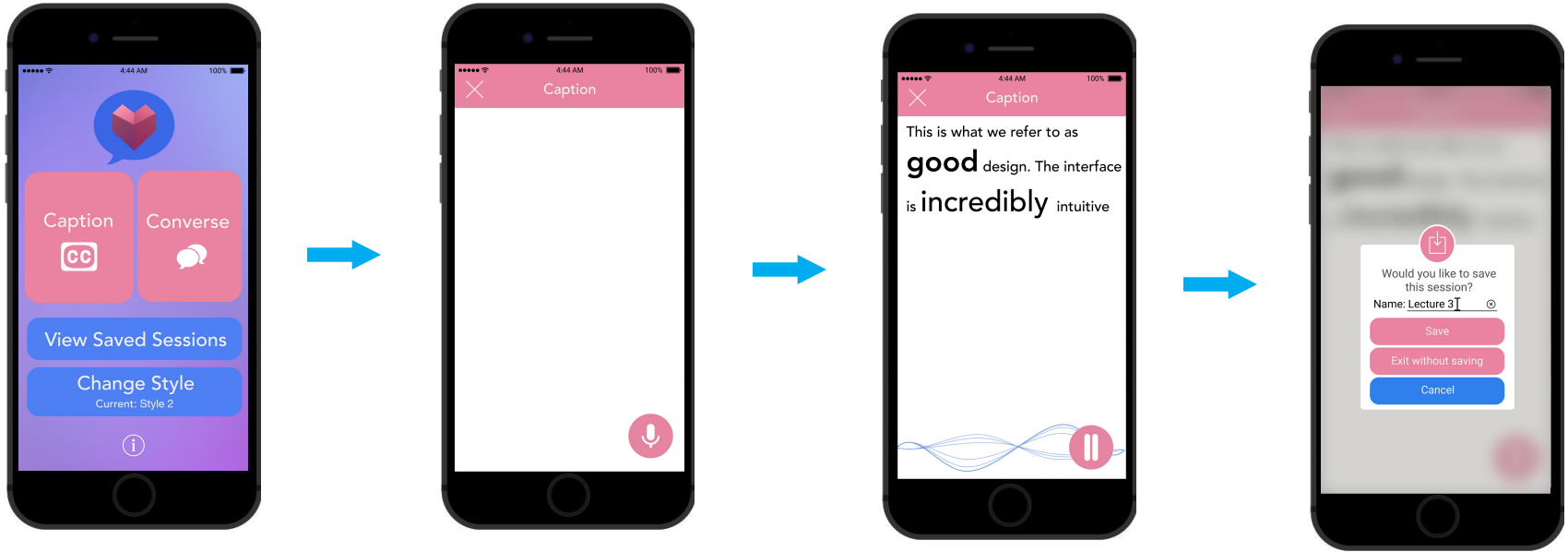

Task 2- 1-on-1 Conversation (Medium)

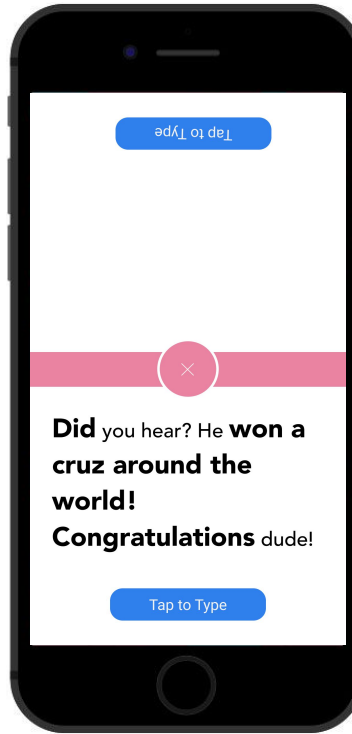
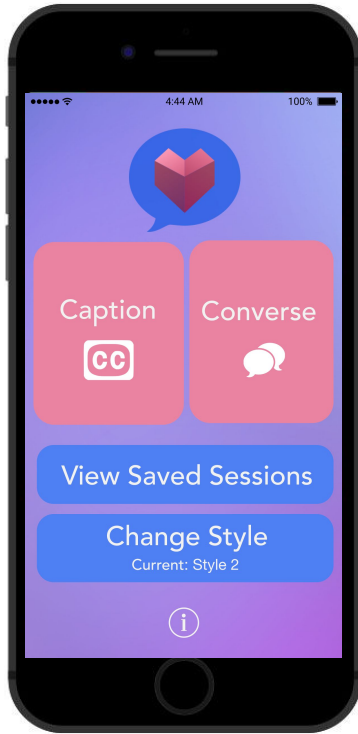

Task 3- iMessage (Complex)

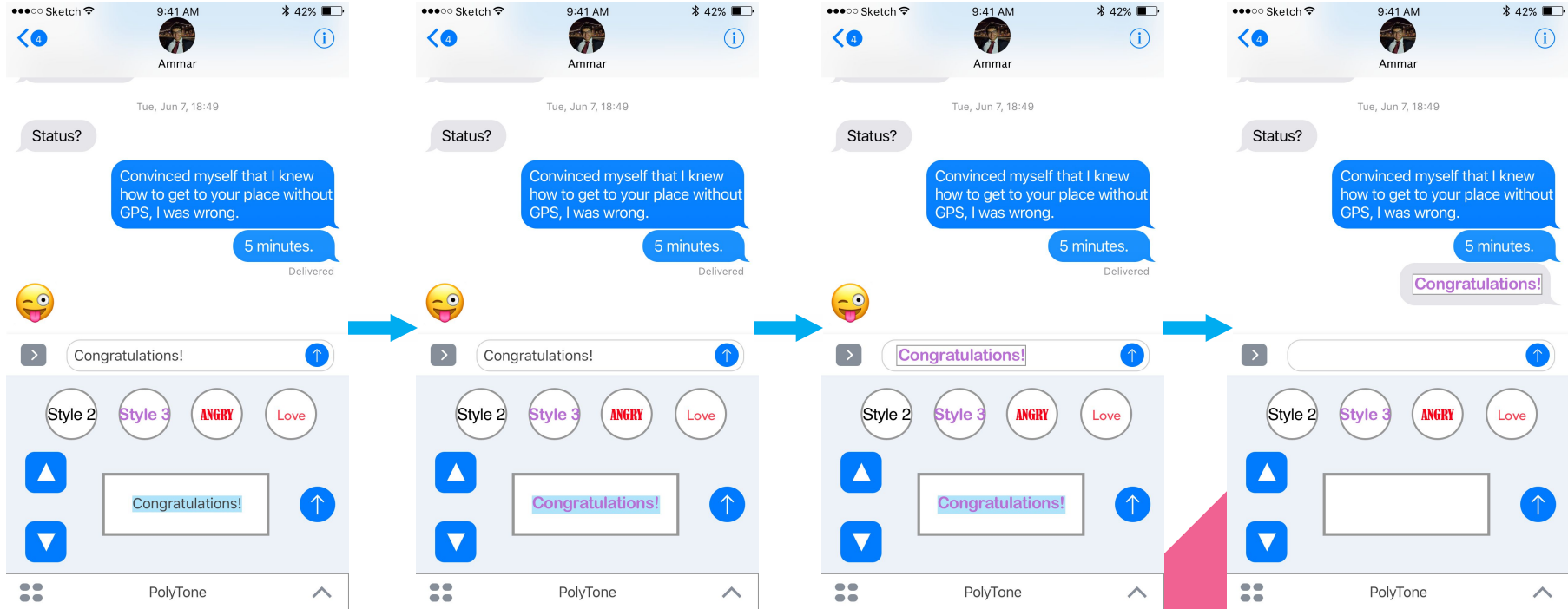

Prototyping Overview



Tools Used: Figma + InVision

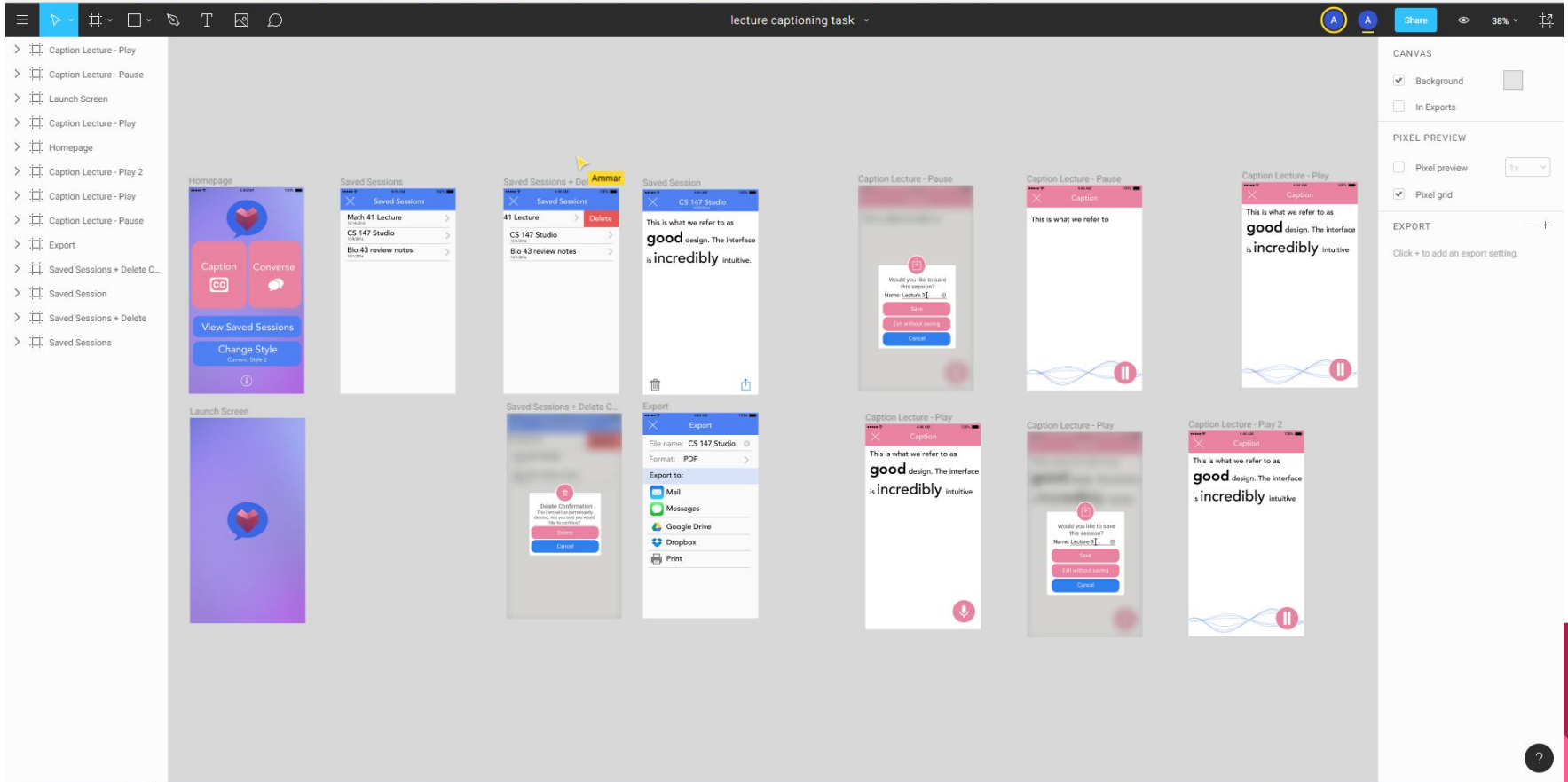

Figma: Pros and Cons

Pros (how it helped)

- Allows for collaborative work (multiple people working at a time)
- Easy to import from sketch
- Easy to export screens/ grouped items

Cons (how it didn't help)

- Difficult to learn to use
- Difficult to piece images/fragments together
- Very slow compared to sketch
- Frequent issues with inserting text



InVision: Pros and Cons

Pros (how it helped)

- Does not need a tutorial to know how to use it
- Allows using a bunch of the most common gestures
- Allows different types of transitions
- Easy to embed into the website

Cons (how it didn't help)

- Lack of interactivity (static frames)
- Sometimes mis-reading gestures

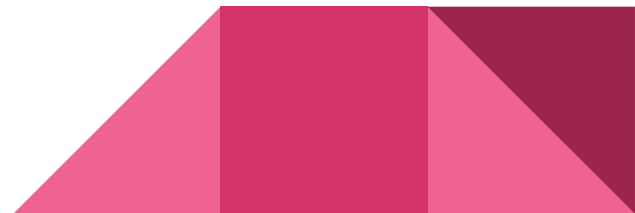

Limitations and Tradeoffs of Current Prototype

- In a lot of cases we didn't give the user a choice in what to do. He was guided.
 - The idea of med-fi is to show the user a sample of how the actual app might look like, and that does not require prototyping every choice.
- Some of the transitions are not exactly how they're gonna look like on the actual app.
- The core concept of the app which is changing the style of font and customize it to convey emotions is not clear in the prototype, since it depends on voice recognition, which made it hard to prototype.



Wizard of Oz Techniques

We used Wizard of Oz techniques where we were supposed to do voice recognition.



Hard Coded Features and Why Required

- All data used like different styles are hard coded.
 - It's hard to allow adding in a med-Fi prototype
- The captioning for lectures is just a text.
 - It's not possible to do transcribing using inversion.



The background is a solid pink color. In the top right corner, there is a decorative graphic consisting of several overlapping geometric shapes: a dark pink square, a medium pink square, and a light pink square, all partially cut off by the edge of the frame.

Thank you

Additional Prototype Slides

Customization Feature:

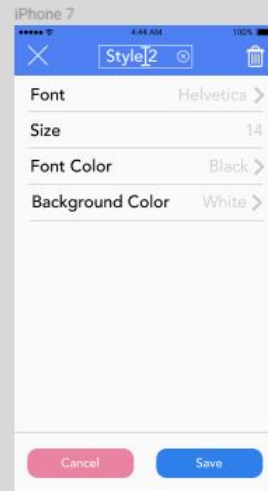
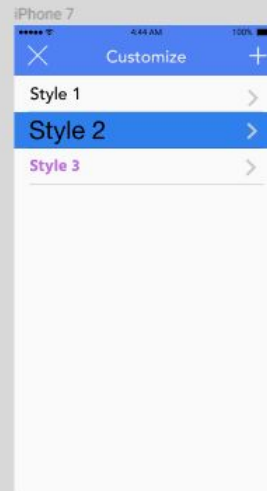
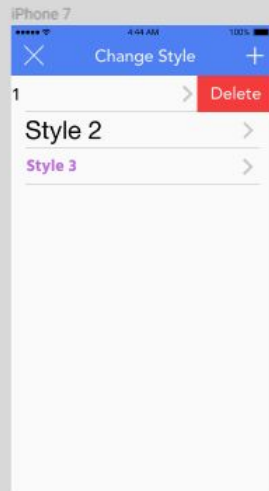
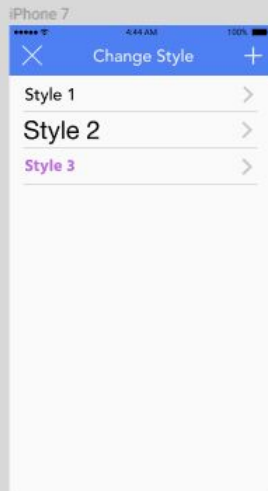
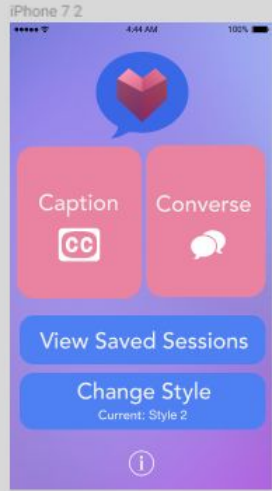

Customization Feature Cont.

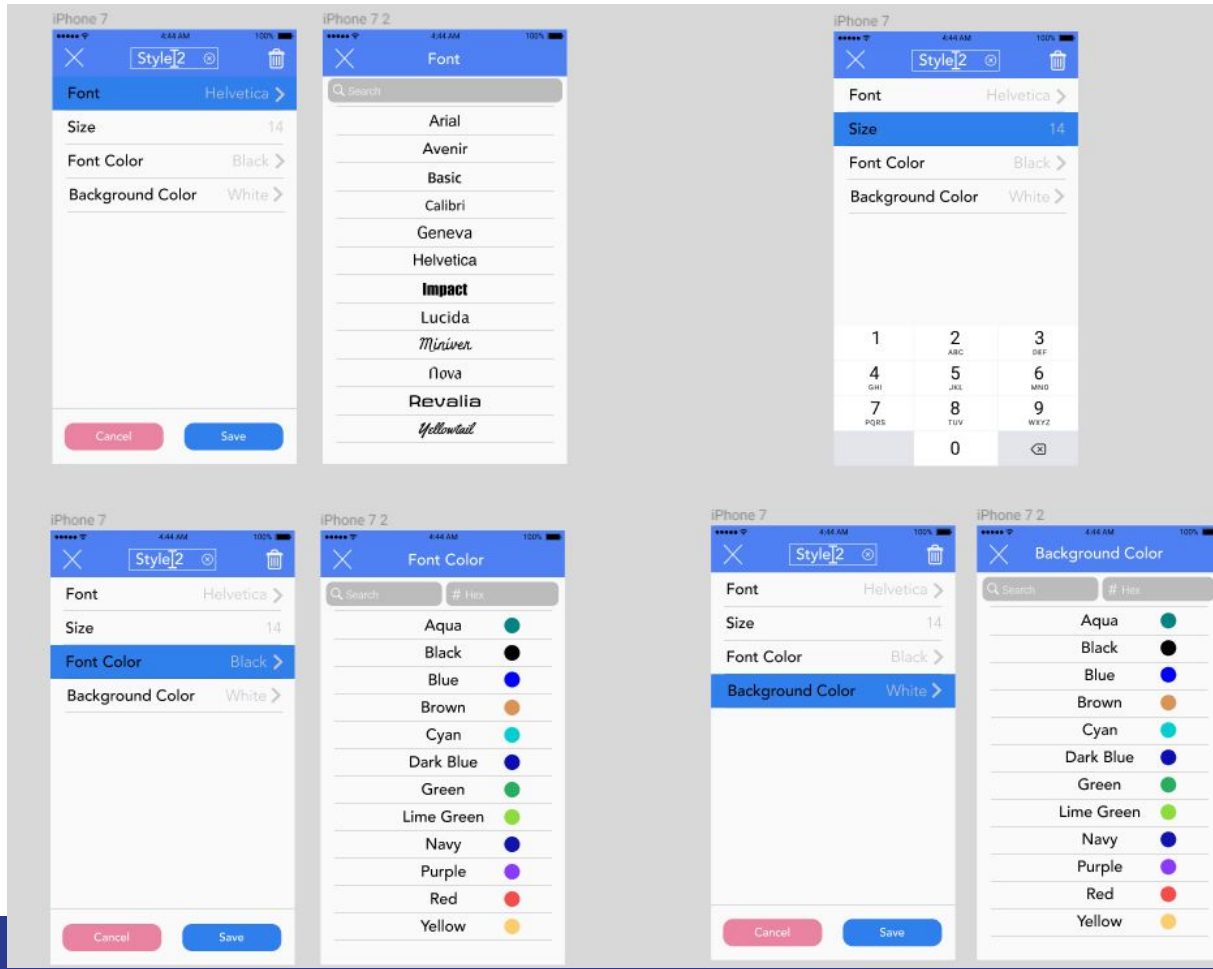

Sharing saved sessions

Homepage

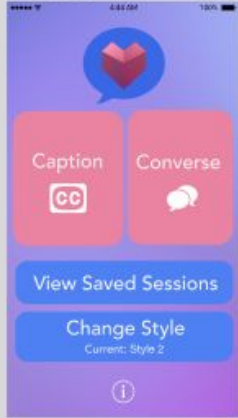

Saved Sessions

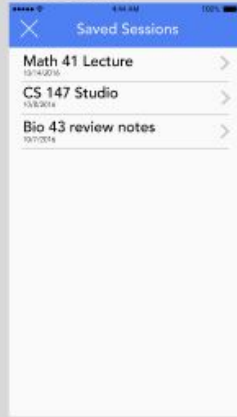

Saved Sessions + Delete

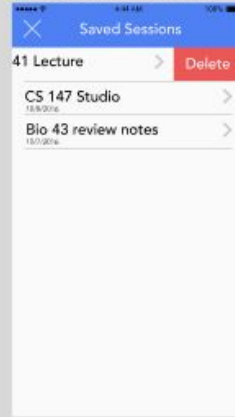

Saved Session



Launch Screen

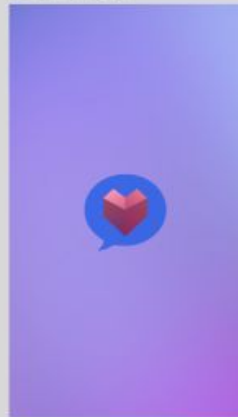

Saved Sessions + Delete C...

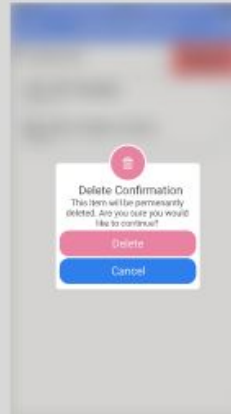

Export

