

Team Covalence



**TED
LI**



**COURTNEY
NOH**



**LOGAN
SHORT**



**EMMA TOWNLEY-
SMITH**

Problem: interacting
meaningfully with material

Problem: interacting
meaningfully with material

Solution: Covalence

Covalence

Organize your thoughts, share
your ideas, connect your world

TASKS:

COMPLEX: create your own map

MEDIUM: explore maps from other users

SIMPLE: share a map you've created or found

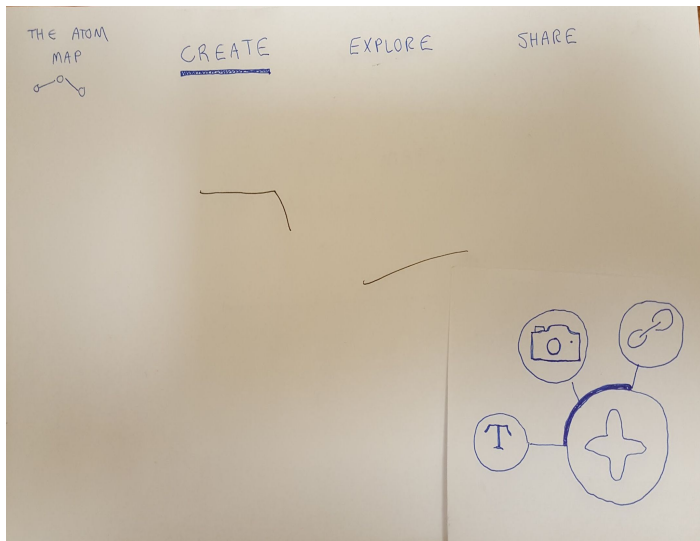

CHANGE #1: replacing “link” with “draw”

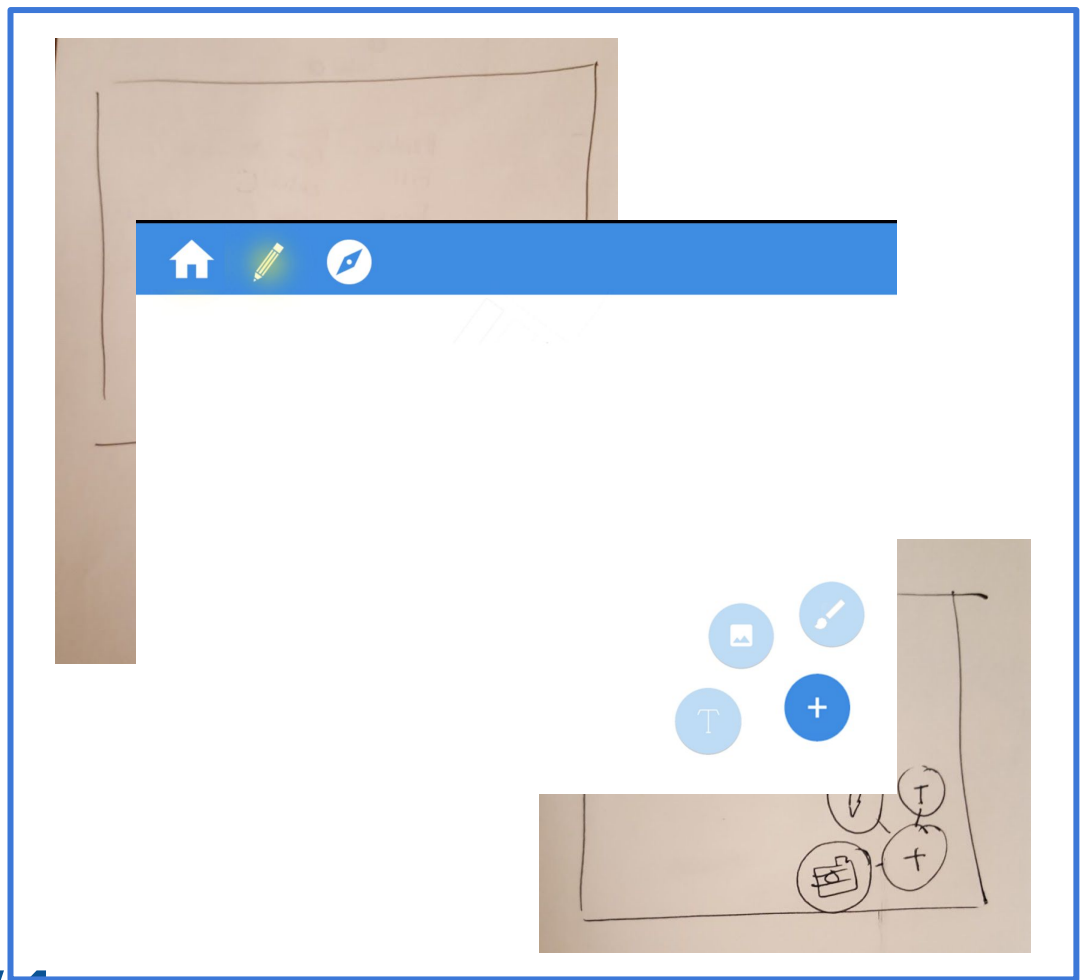
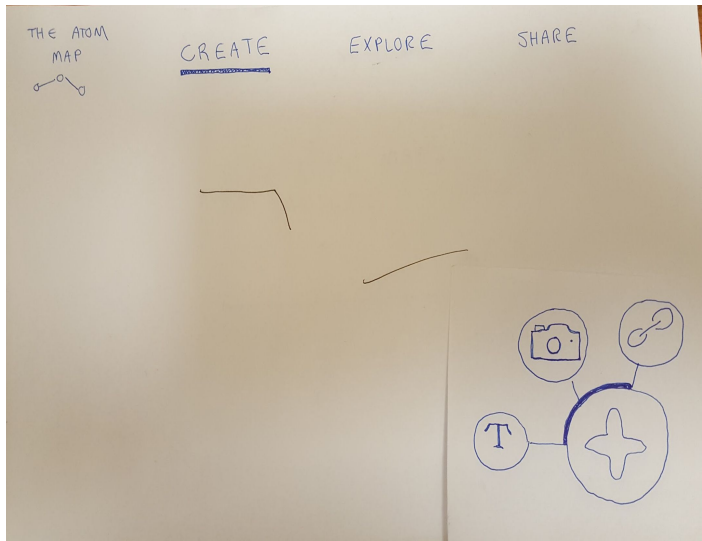

CHANGE #1: replacing “link” with “draw”

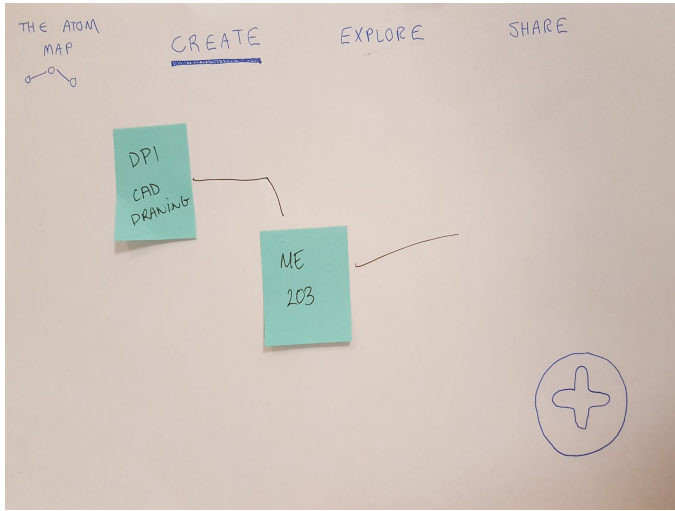

CHANGE #2: making content more robust

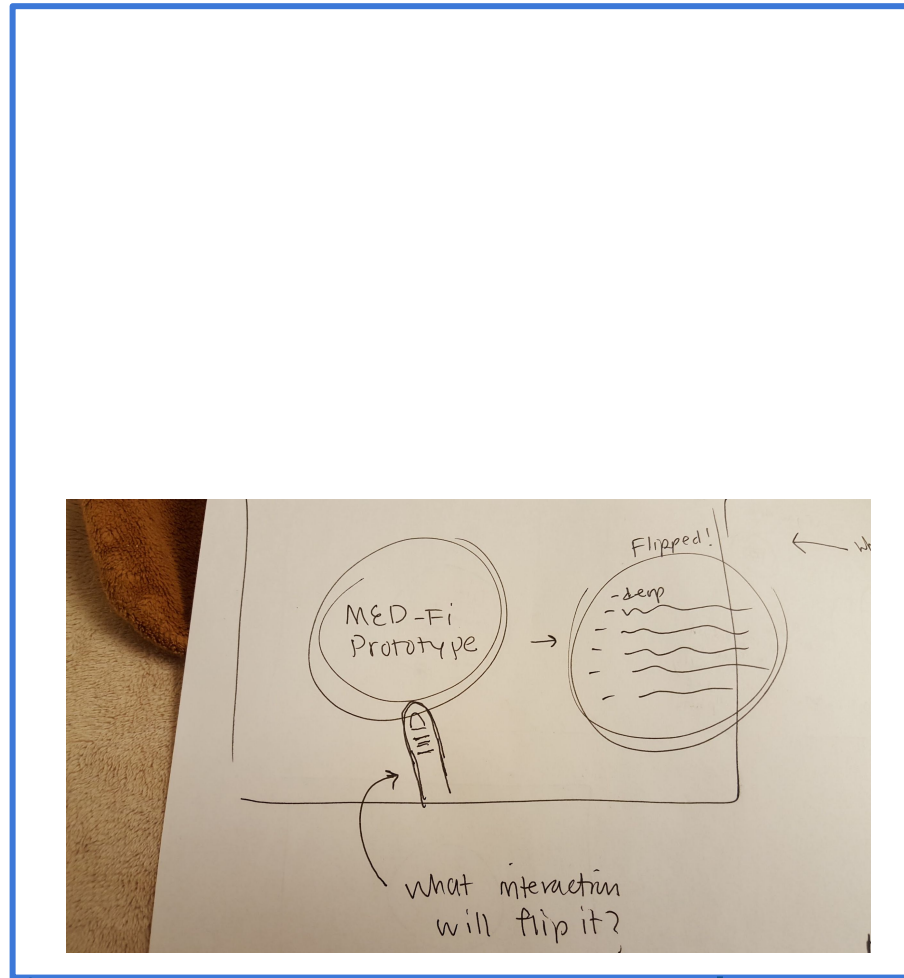
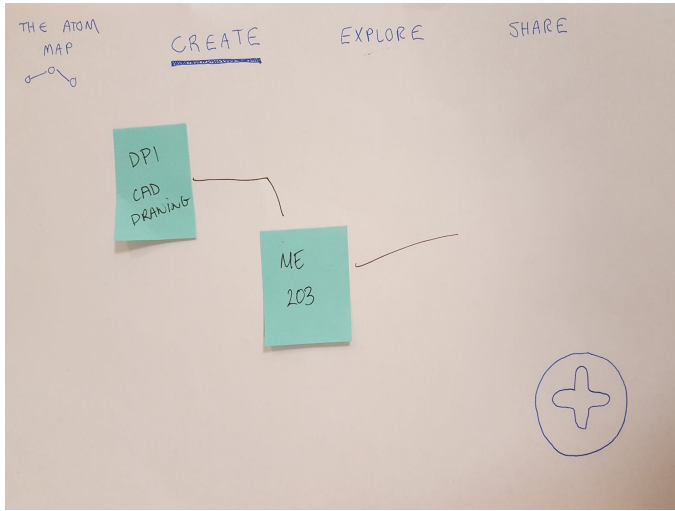

CHANGE #2: making content more robust

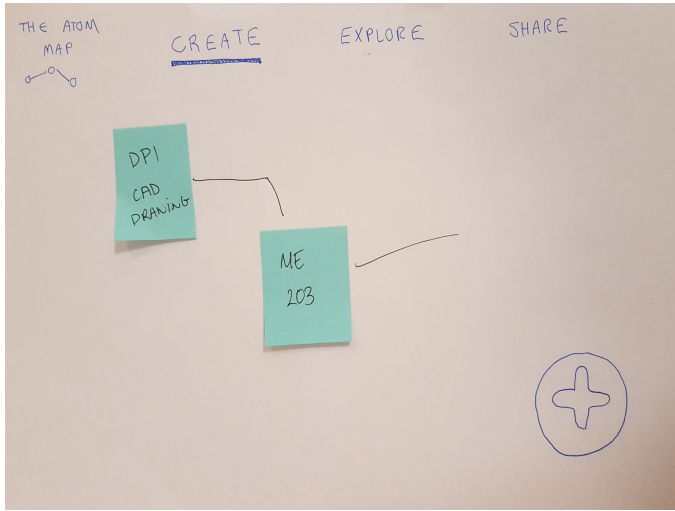

Home Edit Navigation

Save Share

CS 147

Heuristic evaluation:
helps identify and rank severity of UI problems.

Ex criteria: Error prevention,
Recognition rather than recall

WIZARD OF OZ

MED-Fi Prototype

IND

what interaction will flip it?

CHANGE #2: making content more robust

THE ATOM

MAP



CREATE

EXPLORE

SHARE

WHICH MAP WOULD
YOU LIKE TO SHARE?

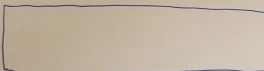
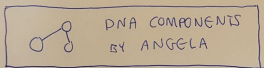
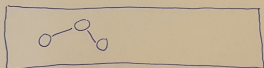

ADD PEOPLE TO
YOUR MAP

+ 1 555-555-5555

+ example@email.com

+ _____

CHANGE #3: Making share a pop up // adding “home”

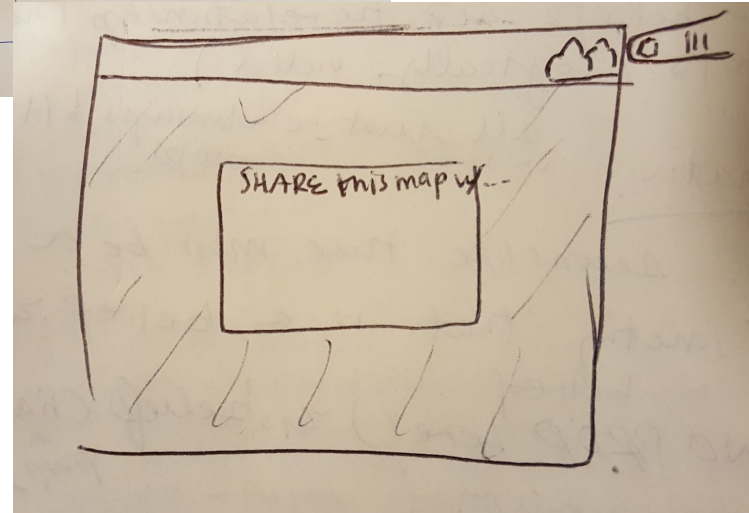
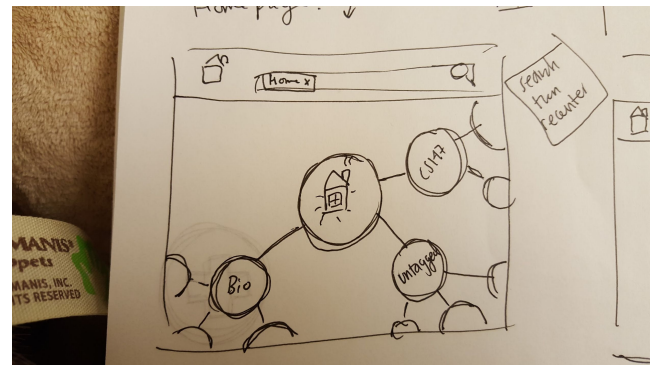
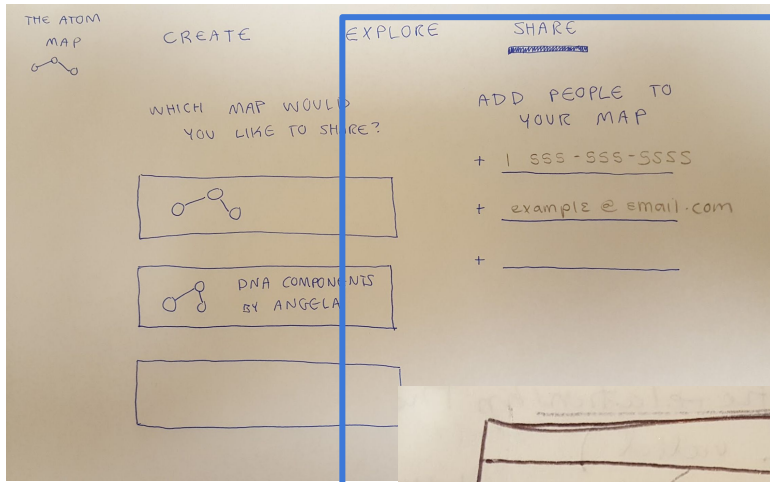

CHANGE #3: Making share a pop up // adding "home"

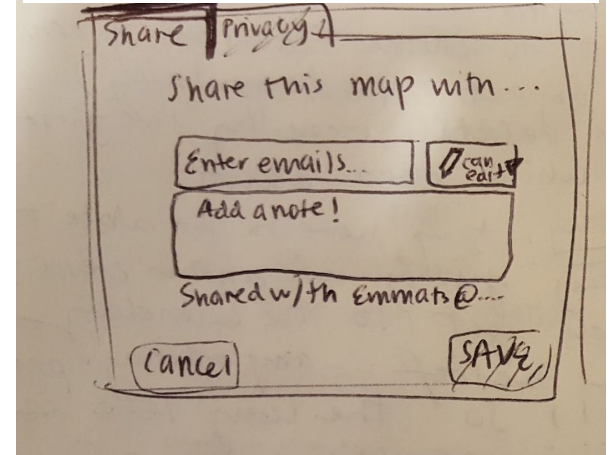
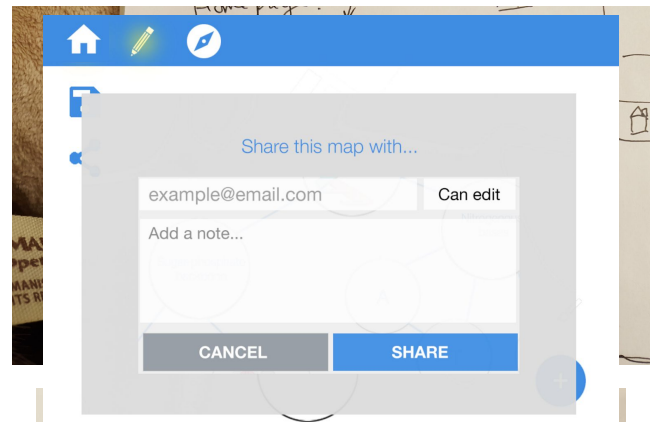
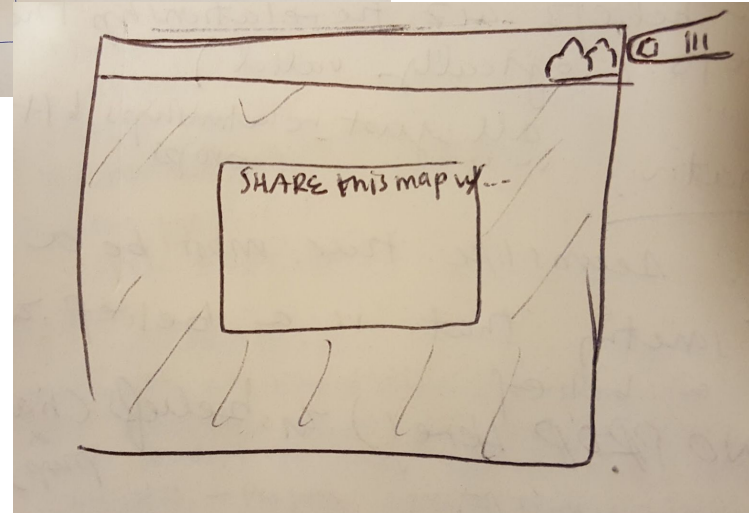
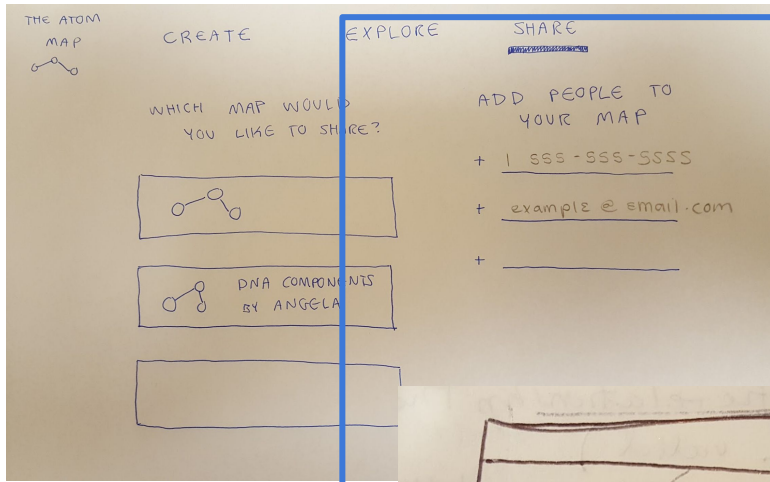

CHANGE #3: Making share a pop up // adding "home"

COMPLEX: create your own map storyboard

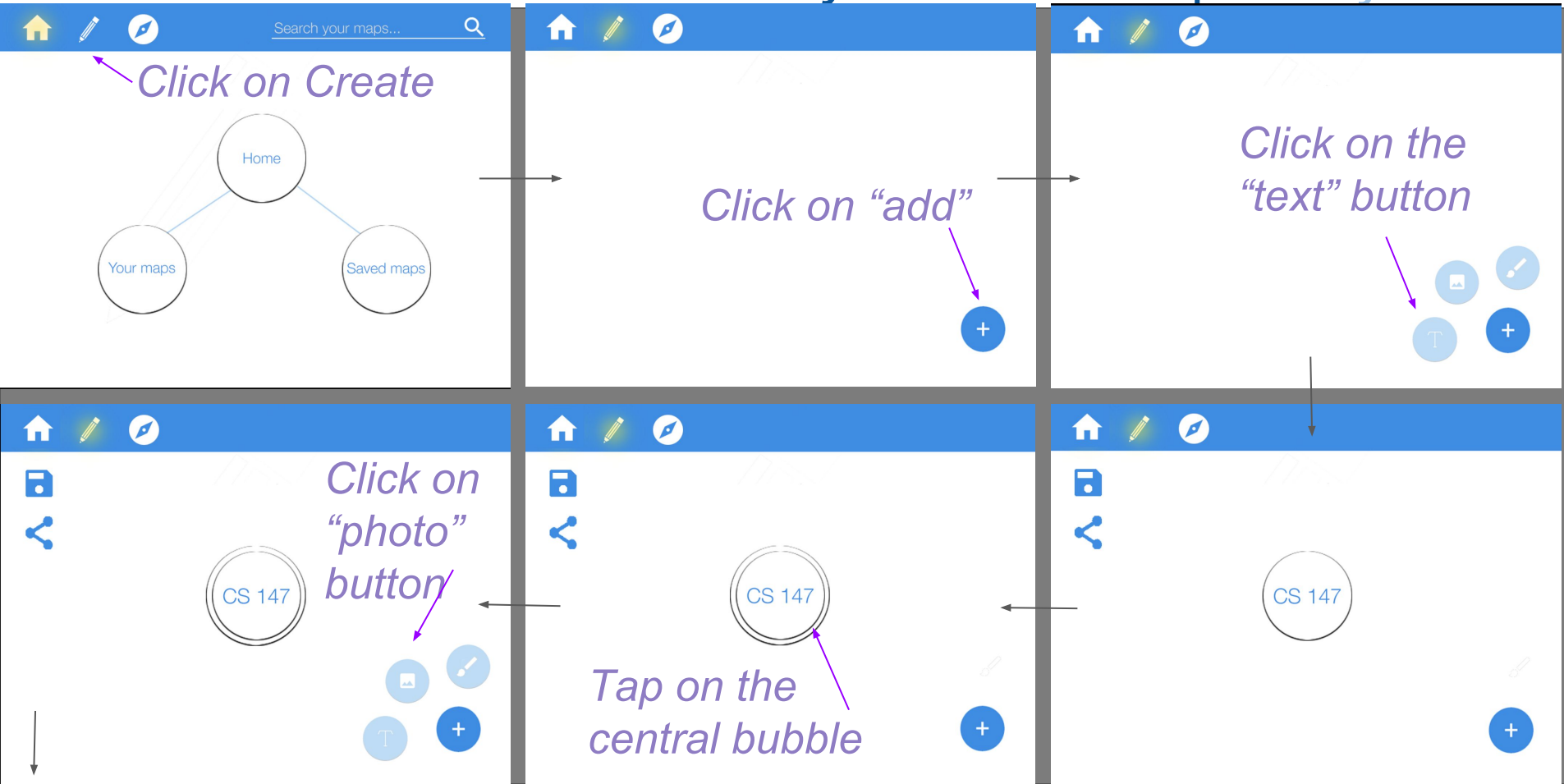

COMPLEX: create your own map storyboard

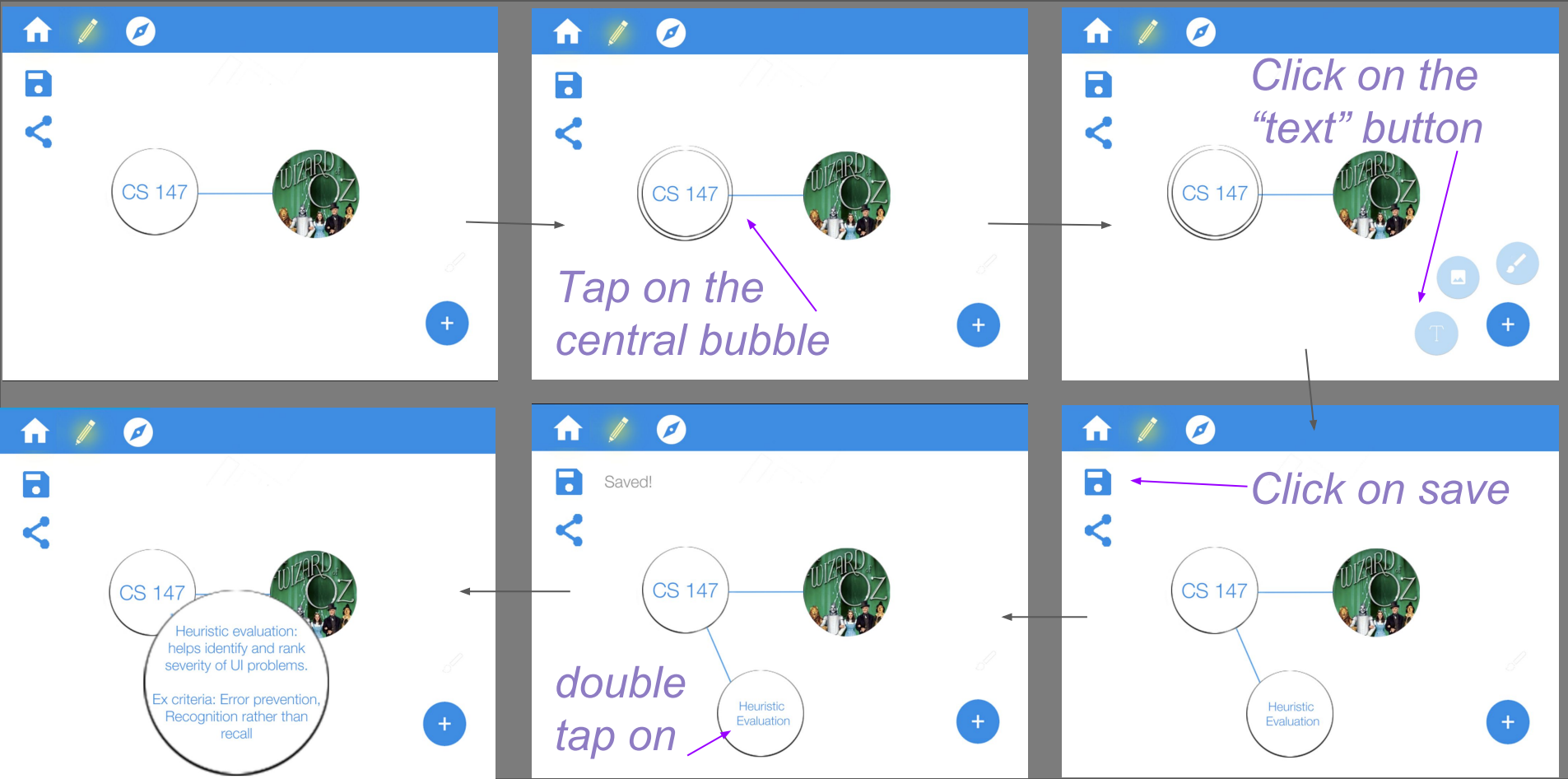

MEDIUM: explore others' maps

storyboard

Search for maps about...

Explore other maps:

- BIOLOGY
- CHEMISTRY
- HISTORY
- DESIGN

click on biology

Biology

- 581 DNA Structure by Mrs. Noh, University High
KEYWORDS: HELIX, ADENINE, PROTEIN
- 465 Enzymes by Dr. Parker, Stanford University
KEYWORDS: LIGASE, PRIMASE, DNA POLYMERASE
- 322 Taxonomy by Mr. Short, Palo Alto High
KEYWORDS: KINGDOM, PHYLUM, CLASS

click on first result

DNA Structure by Mrs. Noh, University High

581

Star icon

Sugar-phosphate backbone

Nitrogenous bases

A, T, C, G

Chemical structures of DNA components

click on star

DNA Structure by Mrs. Noh, University High

581

Star icon (selected)

Sugar-phosphate backbone

Nitrogenous bases

A, T, C, G

Chemical structures of DNA components

SIMPLE: share a map // 2 flows

storyboard

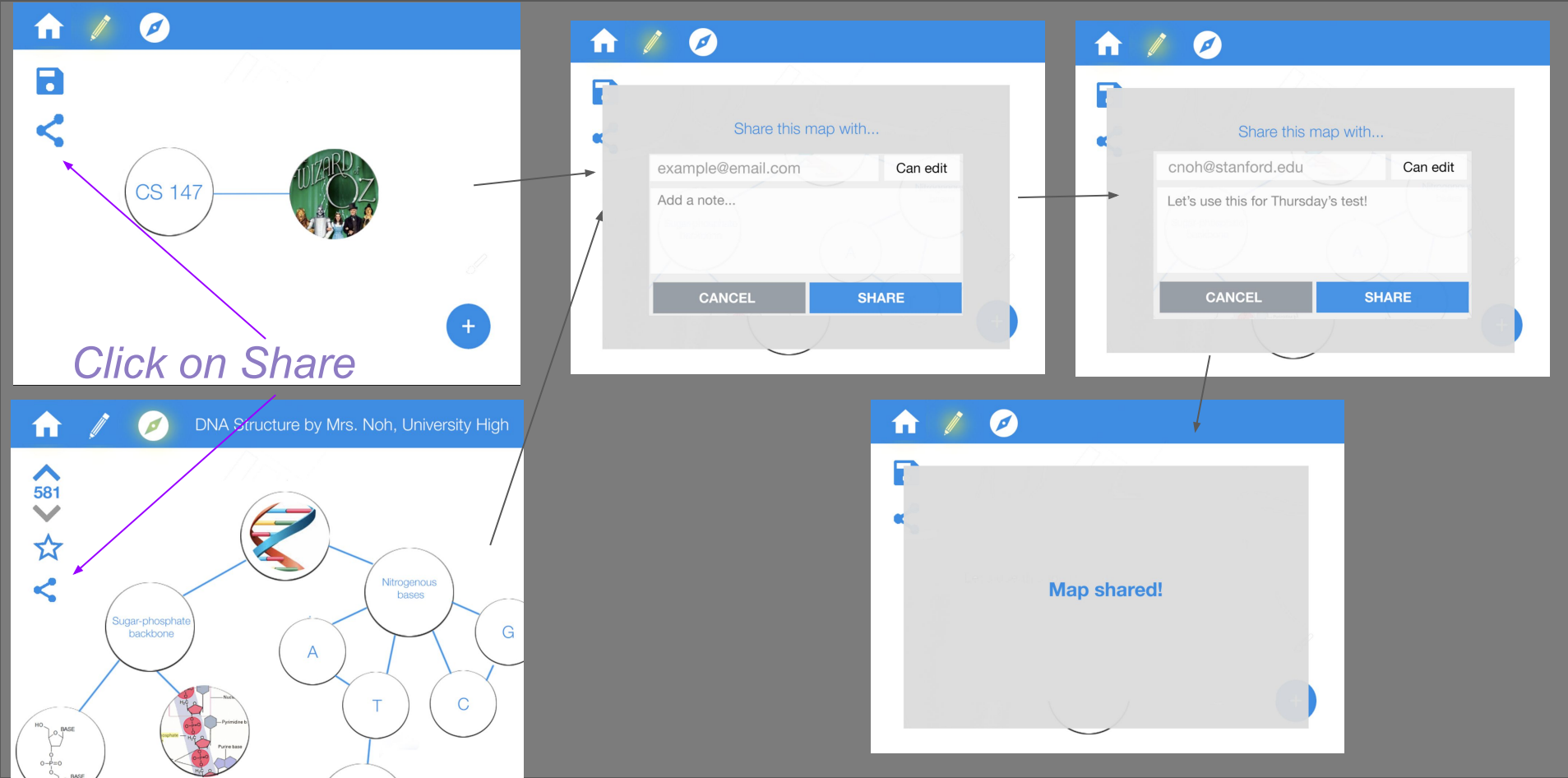

Prototyping: proto.io

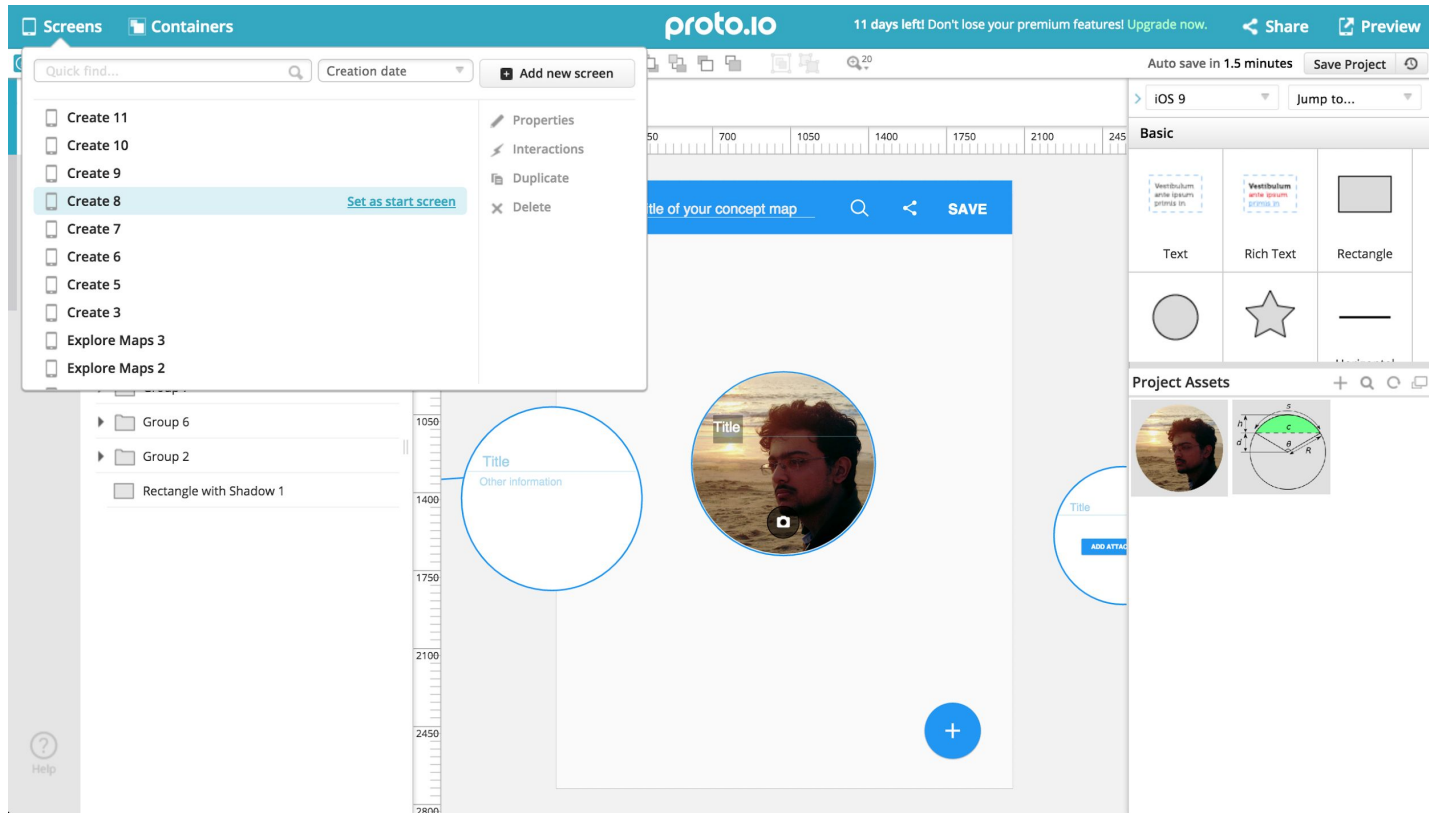

Prototyping: proto.io

- + collaboration!
- + “smart” interactions
- not intuitive
- \$\$\$ after 15 days!
- preview vs. edit screen

Prototyping: ~~proto.io~~ marvel

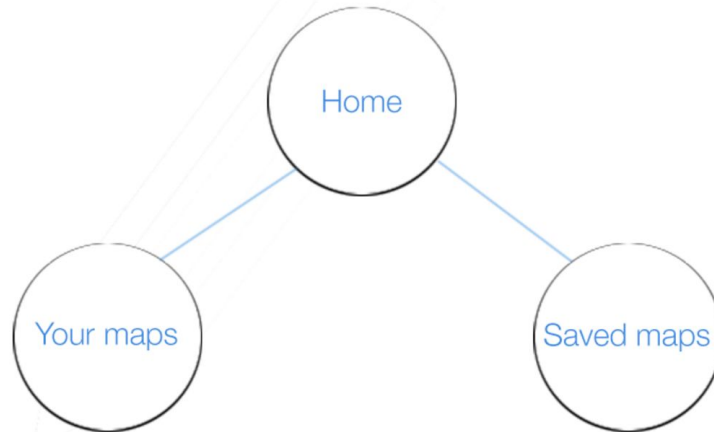

Prototyping: ~~proto.io~~ marvel

- + helped us simplify
- + helped us see things we missed
- doesn't allow for "smart" interactions i.e. touch screen
- not really "creating" your own map

Current Prototype: limitations/tradeoffs

- editing of nodes (color, shape, content)
- ability to “free form” connect
- actually draw/take pictures/upload
- creation of own map
- No Wizard of Oz/hand-coded features

Team Covalence



**TED
LI**



**COURTNEY
NOH**



**LOGAN
SHORT**



**EMMA TOWNLEY-
SMITH**