

Team Covalence



**TED
LI**



**COURTNEY
NOH**



**LOGAN
SHORT**



**EMMA TOWNLEY-
SMITH**

The Atom Map

a visual, mobile workspace

The Atom Map

Organize your thoughts, share
your ideas, connect your world

Interface Designs



Read View



Node View

Read View

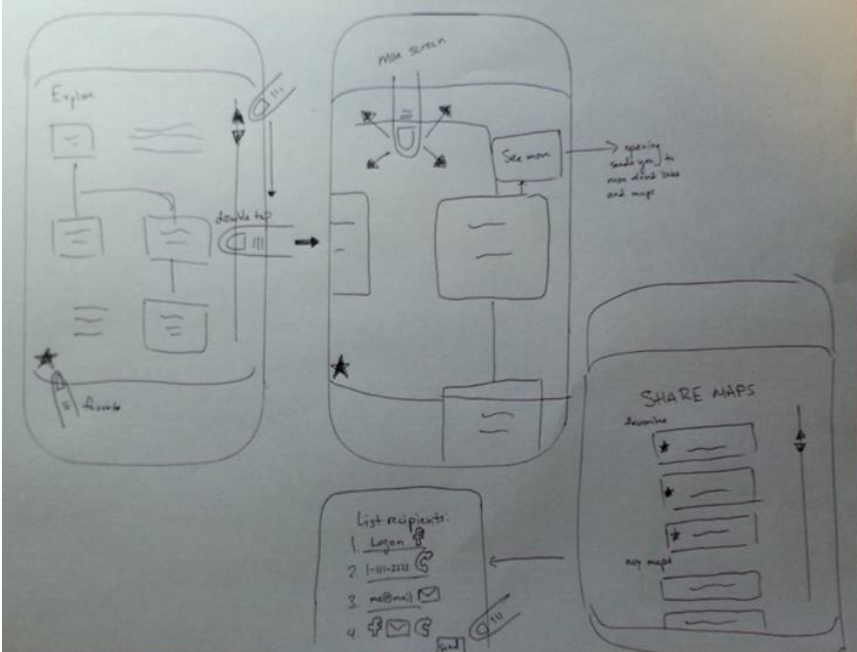
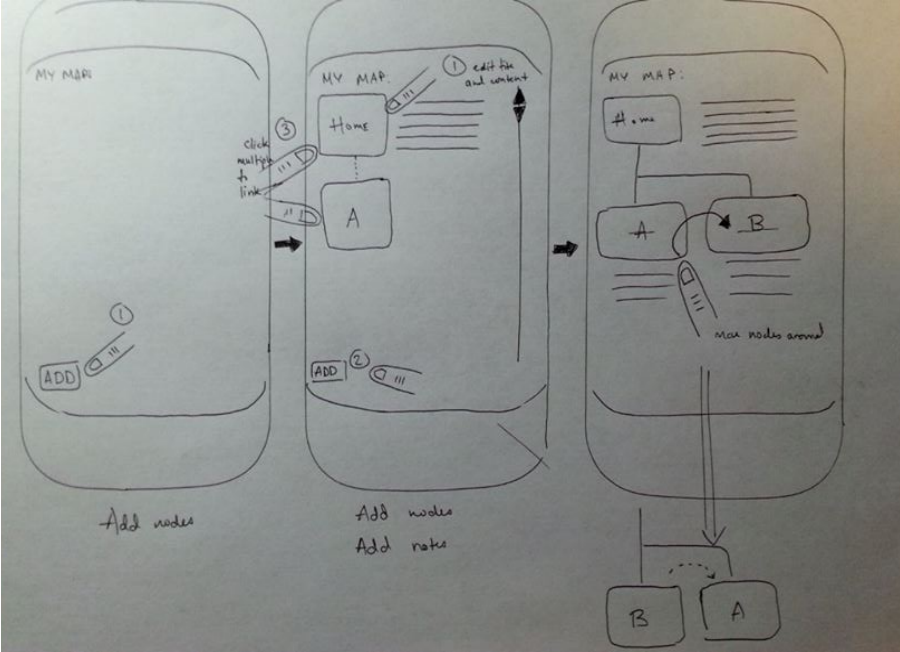

Focus on structure and quality of content

Node View

Focus on flexibility
and speed

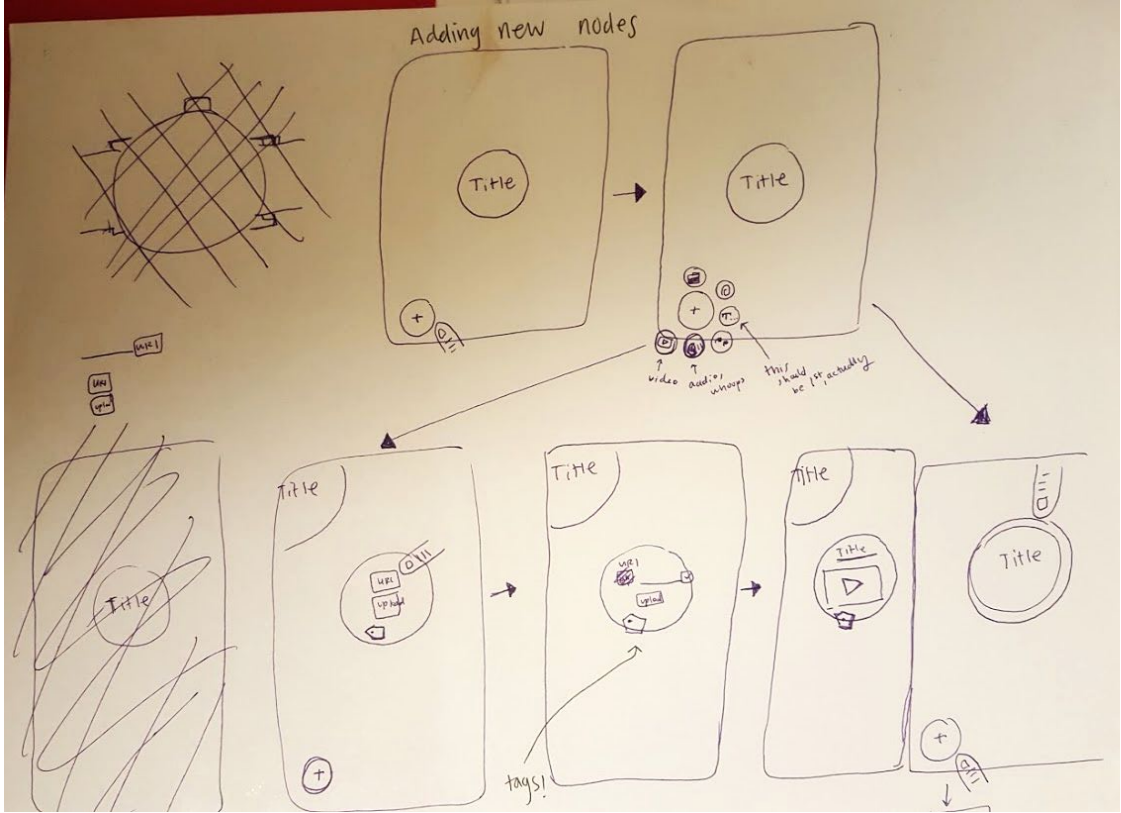

Selected Interface Design: Node View

“Read View” feels static

“Node View” can freely move around on a small screen

Easy to combine many sub-categories

Flexibility, Speed, and Collaboration

Task: Create a Map for User's Class

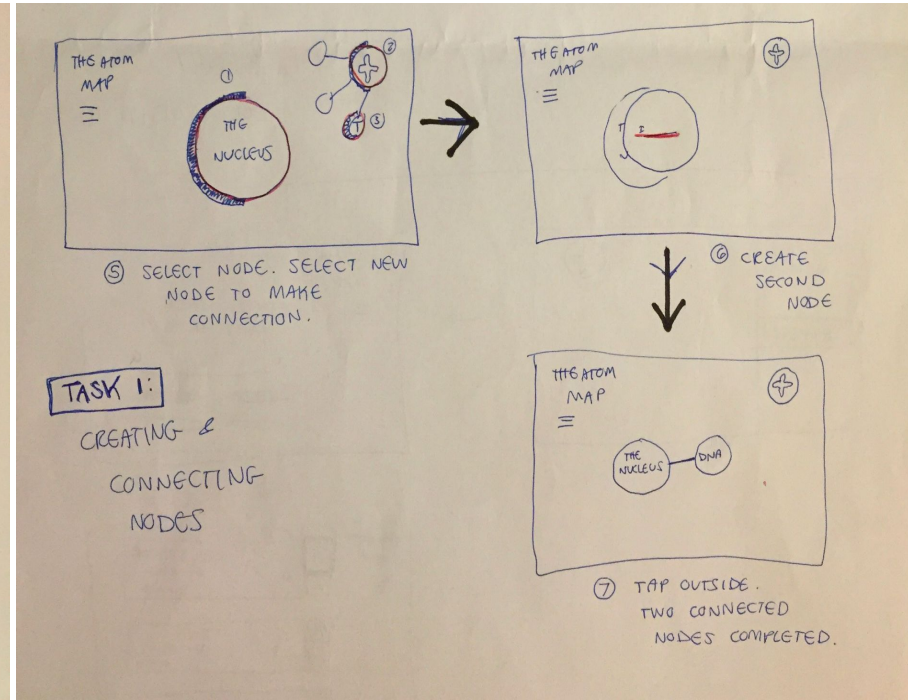
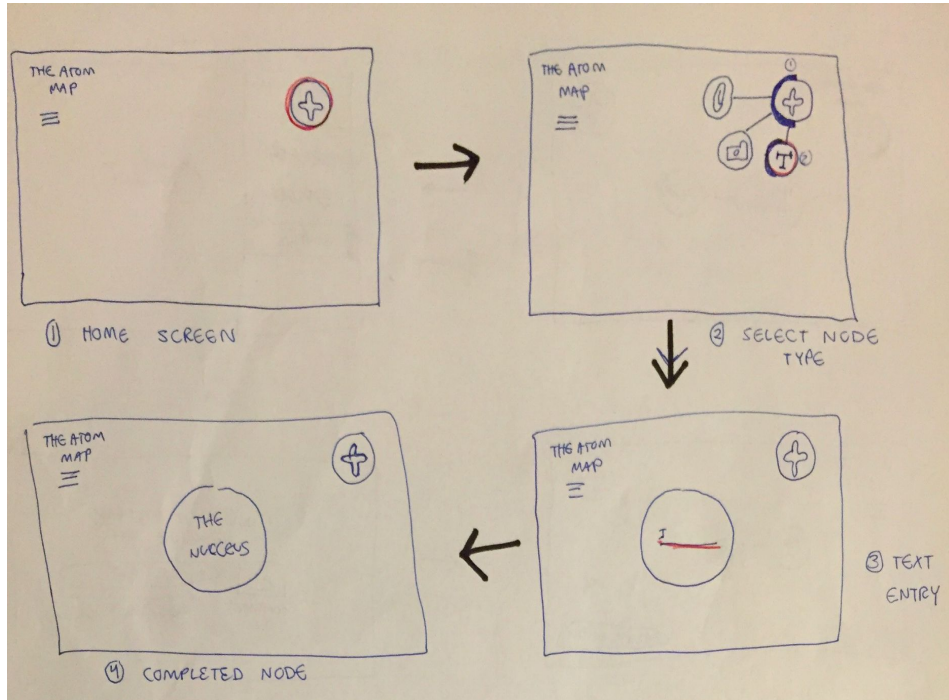

Prototype: Create a Map for User's Class

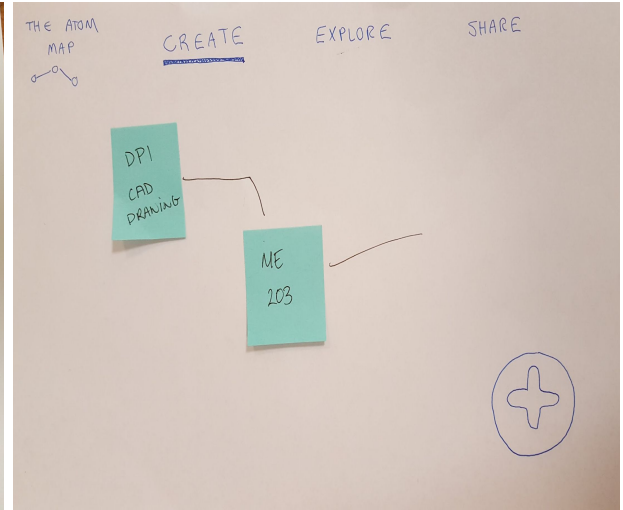
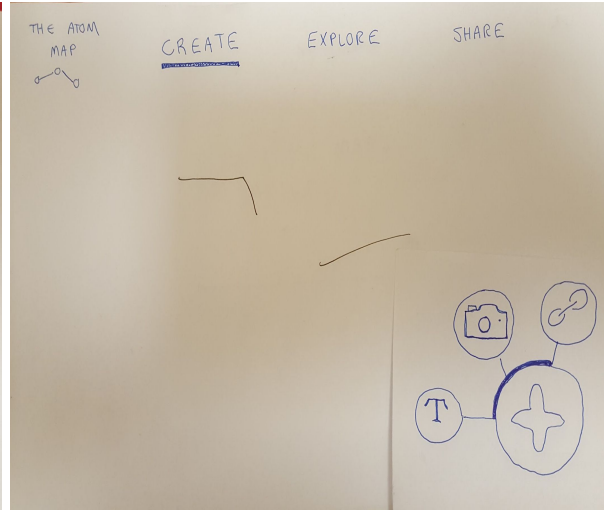
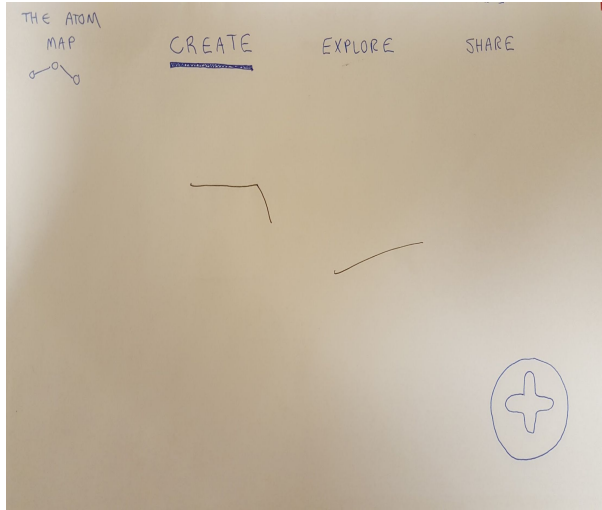

Task: Explore Other Maps For Biology

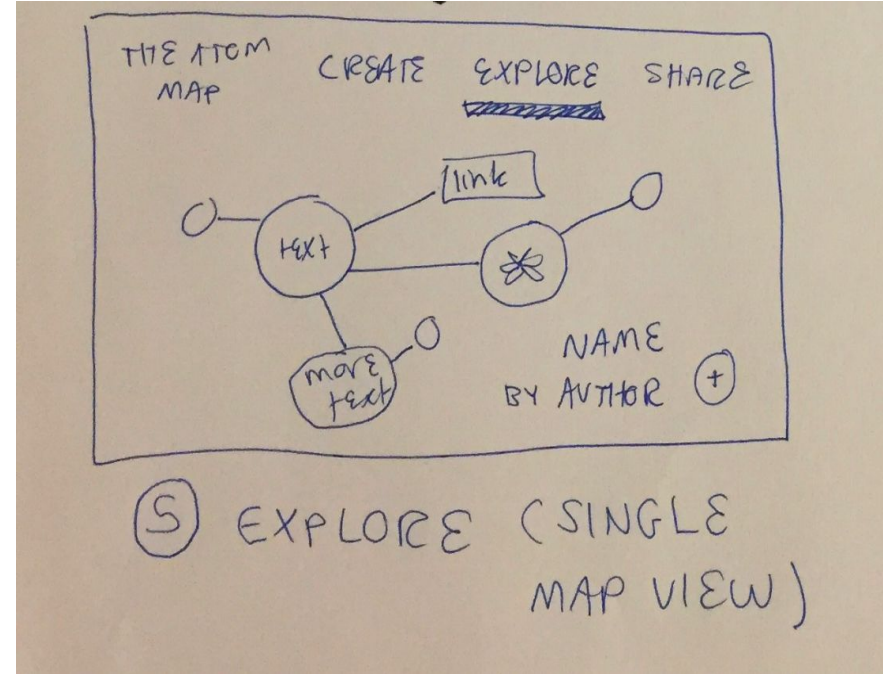
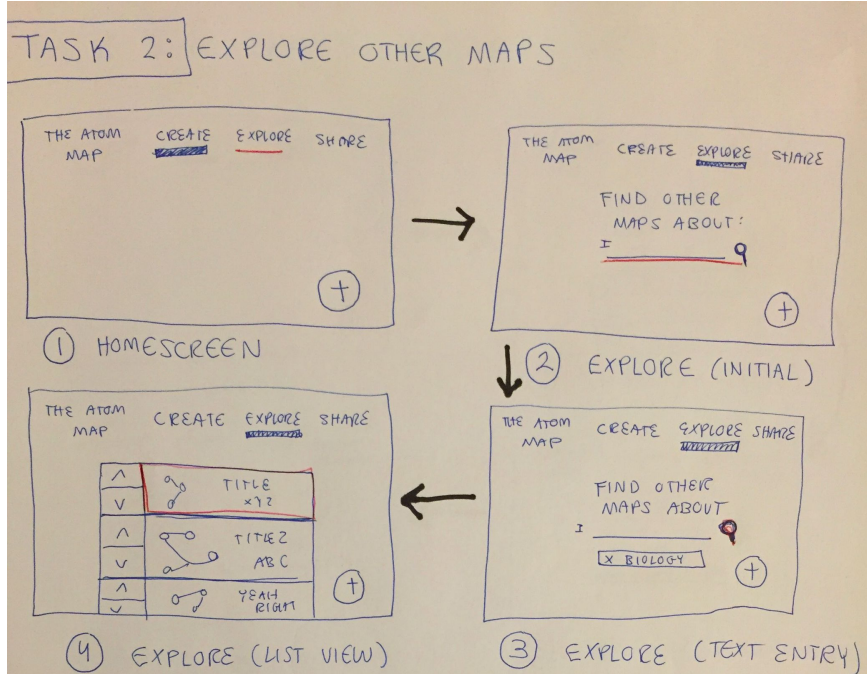

Task: Share a Map You've Found or Created

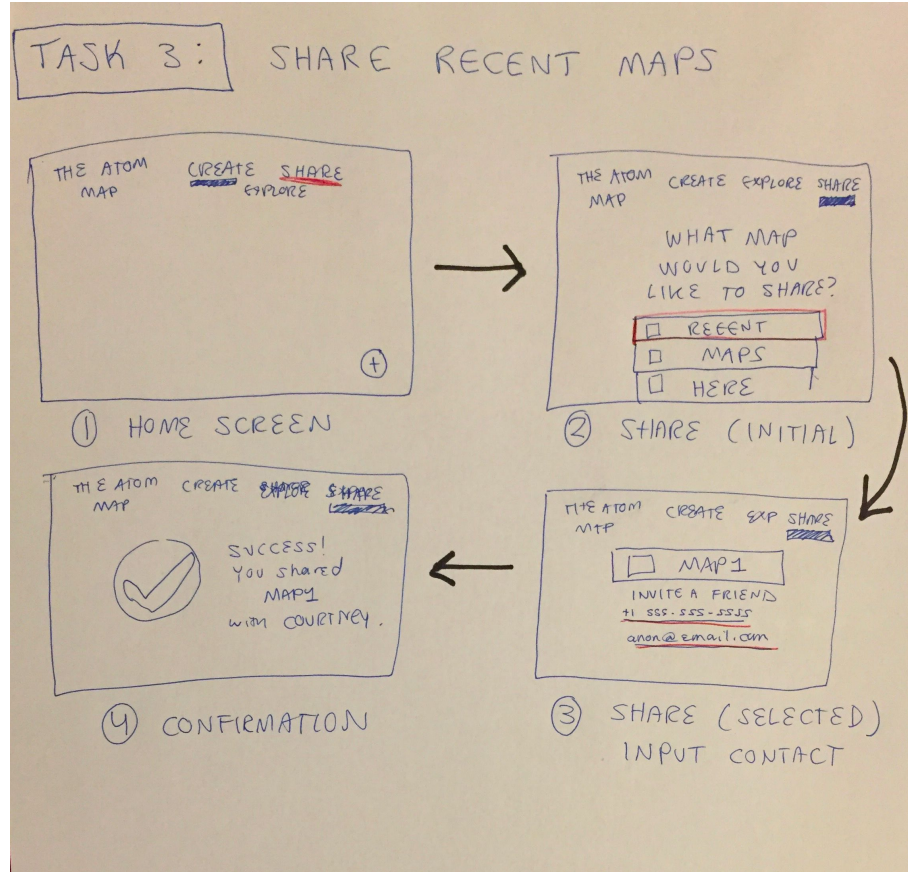

Prototype: Share a Map You've Found or Created

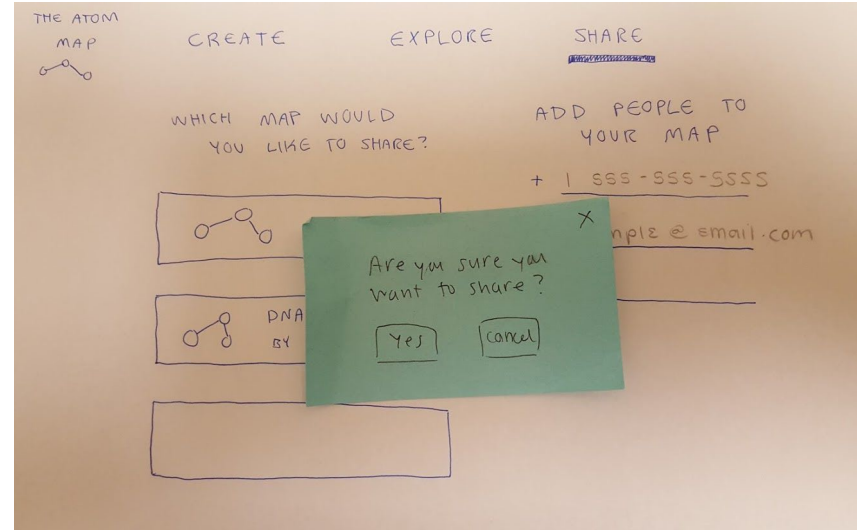
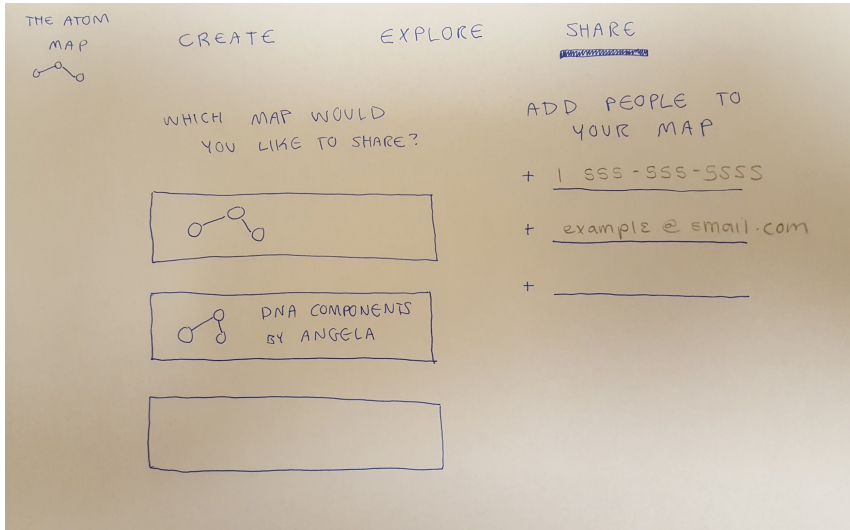

Experiment Method

Participants: Students from different backgrounds

Locations: Common studying or working areas

Incentive: Cherry Turnovers

Experiment Method

Introduce the app

Obtain consent form

Frame testing using subject's class

Describe the task

Have subject think aloud through the task

Number of errors, attempts to perform new actions

Subject 1

Chemistry Student

“

Does this button **make a link between nodes**? I'm not really sure...

It'd be cool to **be able to edit these maps**...drag to rearrange nodes or something.



Subject 1 explains the **map he has created**

Subject 2

Human Biology Student

“

I'm **not really sure where to start**...is this button to move around?

I guess you could **pinch to zoom in and out**...and maybe **click on nodes to get information**.



Subject 2 **listens to an introduction** of the app

Subject 3

Product Design Student

“

I always **go with the one with the most votes**, so I'll go with the first one.

I like **having my own handwriting on things**...the whole point of my making maps is seeing my handwriting.



Subject 3 explains an idea for **map exploration**

Suggested UI Changes

Subjects were unsure
how to connect nodes

Suggested UI Changes

Subjects were unsure
how to connect nodes

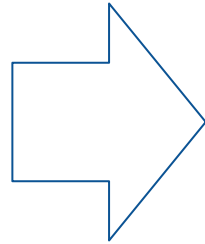

Tutorial or onboarding
process for basic map
creation

Suggested UI Changes

Subjects wanted to
zoom in and out to
explore maps

Suggested UI Changes

Subjects wanted to zoom in and out to explore maps

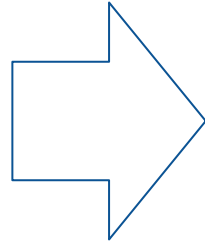

Pinch to zoom in the “Exploration” tab

Suggested UI Changes

Subjects want to freely
interact with maps found
through exploration

Suggested UI Changes

Subjects want to freely interact with maps found through exploration

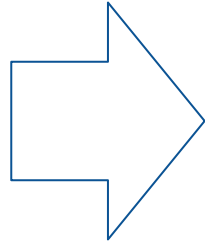

Allow users to download local copies of maps

Suggested UI Changes

Subjects would like to
be able to handwrite on
or around maps

Suggested UI Changes

Subjects would like to be able to handwrite on or around maps

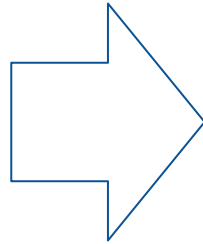

Allow users to make handwritten notes and comments on maps

In summary...

- Users felt that the “Node View” design was an intuitive way to interact with maps
- Added functionality to exploration could improve the experience of collaborating
- Some onboarding may be required